

PLAT OF  
**DOUBLE EAGLE TECH PARK**  
BEING A SUBDIVISION OF LOT 1 EAST RIDGE ADDITION,  
CITY OF SHERIDAN, SHERIDAN COUNTY, WYOMING  
TOTAL ACREAGE = 10.106 ACRES  
TOTAL LOTS = 10

**DECLARATION VACATING PREVIOUS PLATTING**

THIS PLAT IS THE RE-SUBDIVISION OF LOTS 1 EAST RIDGE ADDITION TO THE CITY OF SHERIDAN, WYOMING, AS RECORDED IN DRAWER E OF PLATS, PLAT 14, OF THE RECORDS OF THE SHERIDAN COUNTY CLERK. ALL EARLIER PLATS OR PORTIONS THEREOF ENCOMPASSED BY THE BOUNDARIES OF THIS PLAT ARE HEREBY VACATED.

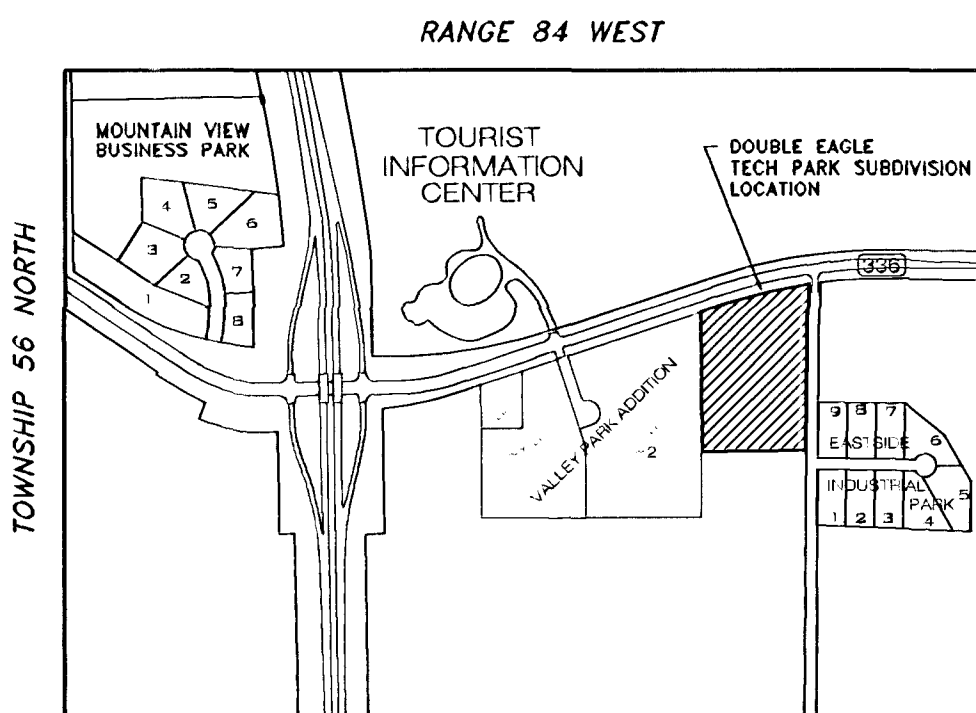

LOCATION MAP  
SCALE: 1" = 1000'



**LEGEND**

- BOUNDARY
- EXISTING LOT OR DEDICATED STREET
- LOT LINES
- UTILITY EASEMENT
- ROADWAY CENTERLINE
- BOUNDARY/INTERIOR LOT CORNER  
SET 2" ALUMINUM CAP PER PE/LS 3864

**DIRECTOR OF PUBLIC WORKS  
CERTIFICATE OF APPROVAL**

THIS PLAT HAS BEEN PREPARED IN ACCORDANCE WITH THE REQUIREMENTS AND PROCEDURES OUTLINED IN THE SUBDIVISION REGULATIONS OF THE CITY OF SHERIDAN AND CERTIFIED THIS 13th DAY OF March, 2006, BY THE DIRECTOR OF PUBLIC WORKS OF SHERIDAN, WYOMING.

**SHERIDAN PLANNING COMMISSION  
CERTIFICATE OF REVIEWAL**

REVIEWED BY THE CITY OF SHERIDAN PLANNING COMMISSION THIS DAY OF MARCH, 2006.

ATTEST: VICE-CHAIRMAN

CHAIRMAN

**CITY COUNCIL OF SHERIDAN  
CERTIFICATE OF APPROVAL**

APPROVED BY THE CITY COUNCIL OF THE CITY OF SHERIDAN, THIS 24th DAY OF MARCH, 2006.

ATTEST: CITY CLERK

Acting Mayor

**CERTIFICATE OF RECORDER**

STATE OF WYOMING }  
COUNTY OF SHERIDAN }  
THIS PLAT WAS FILED FOR RECORD IN THE OFFICE OF THE CLERK AND RECORDER OFFICE AT 1:00 O'CLOCK P.M. ON MARCH 10, 2006, AND IS DULY RECORDED IN BOOK D, PLAT NO. 18

PREPARED BY  
WILLIAM A. MENTOCK  
PE/LS 3864  
MENTOCK ENGINEERING  
1030 NORTH MAIN STREET  
SHERIDAN, WY 82801

PREPARED FOR:  
DOUBLE EAGLE L.L.C.  
P.O. BOX 8793  
SHERIDAN, WY 82801

**CERTIFICATE OF DEDICATION**

KNOW ALL MEN BY THESE PRESENTS THAT THE UNDERSIGNED DOUBLE EAGLE LLC, BEING THE OWNER, PROPRIETOR OR PARTIES OF INTEREST IN THE LAND SHOWN ON THIS PLAT, DO HEREBY CERTIFY:

THAT THE FOREGOING PLAT DESIGNATED AS DOUBLE EAGLE TECH PARK, IS LOCATED IN SECTION 25, TOWNSHIP 56 NORTH, RANGE 84 WEST, OF THE SIXTH PRINCIPAL MERIDIAN, CITY OF SHERIDAN, SHERIDAN COUNTY, WYOMING, MORE PARTICULARLY DESCRIBED AS FOLLOWS:

LOT 1, EAST RIDGE ADDITION TO THE CITY OF SHERIDAN

AND CONTAINS AN AREA OF 10.106 ACRES, MORE OR LESS, AND

THAT THIS SUBDIVISION, AS IT IS DESCRIBED AND AS IT APPEARS ON THIS PLAT, IS MADE WITH THE FREE CONSENT AND IN ACCORDANCE WITH THE DESIRES OF THE UNDERSIGNED OWNER AND PROPRIETOR; AND THAT THIS IS A CORRECT PLAT OF THE AREA AS IT IS DIVIDED INTO LOTS, BLOCKS, STREETS AND EASEMENTS, AND

THAT THE UNDERSIGNED OWNER, OF THE LAND SHOWN AND DESCRIBED ON THIS PLAT DOES HEREBY DEDICATE TO THE CITY OF SHERIDAN AND ITS LICENSEES FOR PUBLIC USE FOR THE INDICATED PURPOSES, ALL STREETS, ALLEYS, EASEMENTS AND OTHER PUBLIC LANDS WITHIN THE BOUNDARY LINES OF THE PLAT, AS INDICATED, AND NOT ALREADY OTHERWISE DEDICATED FOR PUBLIC USE.

UTILITY EASEMENTS, AS DESIGNATED ON THIS PLAT, ARE HEREBY DEDICATED TO THE CITY OF SHERIDAN AND ITS LICENSEES FOR PUBLIC USE FOR THE PURPOSE OF INSTALLING, REPAIRING, REINSTALLING, REPLACING AND MAINTAINING SEWERS, WATERLINES, GAS LINES, ELECTRIC LINES, TELEPHONE LINES, CABLE TV LINES AND OTHER FORMS AND TYPES OF PUBLIC UTILITIES NOW OR HEREAFTER GENERALLY UTILIZED BY THE PUBLIC.

ALL RIGHTS UNDER AND BY VIRTUE OF THE HOMESTEAD EXEMPTION LAWS OF THE STATE OF WYOMING ARE HEREBY WAIVED AND RELEASED.

THE UNDERSIGNED SHERIDAN STATE BANK, HEREINAFTER MORTGAGEE, HOLDS A MORTGAGE IN AND TO LOTS 2 THRU 10 INCLUSIVE OF THE PROPERTY EMBRACED BY THIS SUBDIVISION PLAT, WHICH MORTGAGE WAS FILED WITH THE CLERK OF SHERIDAN COUNTY AND EX-OFFICIO RECORDER OF DEEDS IN BOOK 525 OF MORTGAGES, AT PAGE 346. MORTGAGEE, BY SIGNATURE ON THIS PLAT, CONSENTS TO THE DEDICATIONS MADE HEREIN AND SPECIFICALLY RELEASES ALL STREETS, ALLEYS, PARKS, EASEMENTS, OPEN SPACES AND OTHER AREAS DEDICATED TO THE CITY OF SHERIDAN FOR PUBLIC USE, AS LISTED AND DESCRIBED ON THIS PLAT, FROM THE AFOREMENTIONED MORTGAGE.

THE UNDERSIGNED PINNACLE BANK, HEREINAFTER MORTGAGEE, HOLDS A MORTGAGE IN AND TO LOT 1 ONLY FOR THE PROPERTY EMBRACED BY THIS SUBDIVISION PLAT, WHICH MORTGAGE WAS FILED WITH THE CLERK OF SHERIDAN COUNTY AND EX-OFFICIO RECORDER OF DEEDS IN BOOK 569 OF MORTGAGES, PAGE 655. MORTGAGEE, BY SIGNATURE ON THIS PLAT, CONSENTS TO THE DEDICATIONS MADE HEREIN AND SPECIFICALLY RELEASES ALL STREETS, ALLEYS, PARKS, EASEMENTS, OPEN SPACES AND OTHER AREAS DEDICATED TO THE CITY OF SHERIDAN FOR PUBLIC USE, AS LISTED AND DESCRIBED ON THIS PLAT, FROM THE AFOREMENTIONED MORTGAGE.

THE UNDERSIGNED UNITED STATES SMALL BUSINESS ADMINISTRATION, TRANSFERRED FROM FRONTIER CERTIFIED DEVELOPMENT COMPANY, INC., HEREINAFTER MORTGAGEE, HOLDS A MORTGAGE IN AND TO LOT 1 ONLY OF THE PROPERTY EMBRACED BY THIS SUBDIVISION PLAT, WHICH MORTGAGE WAS FILED WITH THE CLERK OF SHERIDAN COUNTY AND EX-OFFICIO RECORDER OF DEEDS IN BOOK 622 OF MORTGAGES, PAGE 468. MORTGAGEE, BY SIGNATURE ON THIS PLAT, CONSENTS TO THE DEDICATIONS MADE HEREIN AND SPECIFICALLY RELEASES ALL STREETS, ALLEYS, PARKS, EASEMENTS, OPEN SPACES AND OTHER AREAS DEDICATED TO THE CITY OF SHERIDAN FOR PUBLIC USE, AS LISTED AND DESCRIBED ON THIS PLAT, FROM THE AFOREMENTIONED MORTGAGE.

EXECUTED THIS 23rd DAY OF February, 2006.

BY: Ronald J. Patterson  
DOUBLE EAGLE LLC (LOTS 2 THRU 10 INCLUSIVE)  
RON PATTERSON, AUTHORIZED REPRESENTATIVE

STATE OF WYOMING }  
COUNTY OF SHERIDAN } SS

THE FOREGOING INSTRUMENT WAS ACKNOWLEDGED BEFORE ME THIS 23rd DAY OF February, 2006, BY RON PATTERSON, AUTHORIZED REPRESENTATIVE FOR DOUBLE EAGLE LLC.

MY COMMISSION EXPIRES: July 24, 2007

ATTEST: Genea Trojan  
NOTARY PUBLIC

BY: Ronald J. Patterson  
DOUBLE EAGLE HOSPITALITY GROUP, LLC (LOT 1 ONLY)  
RON PATTERSON, AUTHORIZED REPRESENTATIVE

STATE OF WYOMING }  
COUNTY OF SHERIDAN } SS

THE FOREGOING INSTRUMENT WAS ACKNOWLEDGED BEFORE ME THIS 23rd DAY OF February, 2006, BY RON PATTERSON, AUTHORIZED REPRESENTATIVE FOR DOUBLE EAGLE HOSPITALITY GROUP, LLC

MY COMMISSION EXPIRES: July 24, 2007

ATTEST: Genea Trojan  
NOTARY PUBLIC

BY: Monty Schaefer  
AUTHORIZED REPRESENTATIVE FOR SHERIDAN STATE BANK (LOTS 2 THRU 10 INCLUSIVE)

STATE OF WYOMING }  
COUNTY OF SHERIDAN } SS

THE FOREGOING INSTRUMENT WAS ACKNOWLEDGED BEFORE ME THIS 23rd DAY OF February, 2006, BY Monty Schaefer

MY COMMISSION EXPIRES: 9-15-2007

ATTEST: Kathy Perry  
NOTARY PUBLIC

BY: Natali Yumoon  
AUTHORIZED REPRESENTATIVE FOR PINNACLE BANK (LOT 1 ONLY)

STATE OF WYOMING }  
COUNTY OF SHERIDAN } SS

THE FOREGOING INSTRUMENT WAS ACKNOWLEDGED BEFORE ME THIS 23rd DAY OF February, 2006, BY Genea Trojan

MY COMMISSION EXPIRES: July 24, 2007

ATTEST: Becky Schaefer  
NOTARY PUBLIC

BY: Genea Trojan  
AUTHORIZED REPRESENTATIVE FOR UNITED STATES SMALL BUSINESS ADMINISTRATION (LOT 1 ONLY)

STATE OF WYOMING }  
COUNTY OF SHERIDAN } SS

THE FOREGOING INSTRUMENT WAS ACKNOWLEDGED BEFORE ME THIS 23rd DAY OF February, 2006, BY Genea Trojan

MY COMMISSION EXPIRES: July 24, 2007

ATTEST: Genea Trojan  
NOTARY PUBLIC