

RECORD OF SURVEY BOUNDARY LINE ADJUSTMENT

SE1/4 OF SECTION 17, TOWNSHIP 56 NORTH, RANGE 84 WEST, 6TH P.M.,
SHERIDAN COUNTY, WYOMING.

LEGAL DESCRIPTIONS:

PARCEL 1

A TRACT OF LAND SITUATED IN THE SE1/4 OF SECTION 17, TOWNSHIP 56 NORTH, RANGE 84 WEST, 6TH P.M., SHERIDAN COUNTY, WYOMING; SAID TRACT OF LAND BEING MORE PARTICULARLY DESCRIBED AS FOLLOWS:

BEGINNING AT THE SOUTHEAST CORNER OF SAID SECTION 17 (MONUMENTED WITH A MILITARY MONUMENT MM-24); THENCE N87°30'48"W, 153.90 FEET ALONG THE SOUTH LINE OF SAID SE1/4 TO A POINT, SAID POINT BEING THE SOUTHEAST CORNER OF A TRACT OF LAND DESCRIBED IN BOOK 441 OF DEEDS, PAGE 350 (MONUMENTED WITH A 1 1/2" ALUMINUM CAP PER PLS 2615); THENCE N57°24'41"W, 384.34 FEET ALONG THE EAST LINE OF SAID TRACT DESCRIBED IN BOOK 441 OF DEEDS, PAGE 350 TO A POINT, SAID POINT BEING THE NORTHEAST CORNER OF SAID TRACT DESCRIBED IN BOOK 441 OF DEEDS, PAGE 350 (MONUMENTED WITH A 1 1/2" ALUMINUM CAP PER PLS 2615); THENCE N73°36'19"W, 417.19 FEET ALONG THE NORTH LINE OF SAID TRACT DESCRIBED IN BOOK 441 OF DEEDS, PAGE 350 TO A POINT; THENCE N10°08'14"E, 295.75 FEET TO A POINT, SAID POINT LYING ON THE CENTERLINE OF SOLDIER CREEK; THENCE, ALONG SAID CENTERLINE OF SOLDIER CREEK THROUGH A NON-TANGENT CURVE TO THE RIGHT, HAVING A CENTRAL ANGLE OF 78°57'21", A RADIUS OF 10.00 FEET, AN ARC LENGTH OF 13.78 FEET, A CHORD BEARING OF S48°42'26"E, AND A CHORD LENGTH OF 12.72 FEET TO A POINT; THENCE S09°13'46"E, 32.62 FEET ALONG SAID CENTERLINE TO A POINT; THENCE S29°39'48"E, 21.01 FEET ALONG SAID CENTERLINE TO A POINT; THENCE S17°55'33"E, 57.00 FEET ALONG SAID CENTERLINE TO A POINT; THENCE, ALONG SAID CENTERLINE THROUGH A CURVE TO THE LEFT, HAVING A CENTRAL ANGLE OF 81°25'54", A RADIUS OF 30.00 FEET, AN ARC LENGTH OF 42.64 FEET, A CHORD BEARING OF S58°38'30"E, AND A CHORD LENGTH OF 39.14 FEET TO A POINT; THENCE, ALONG SAID CENTERLINE THROUGH A REVERSE CURVE TO THE RIGHT, HAVING A CENTRAL ANGLE OF 38°46'45", A RADIUS OF 45.00 FEET, AN ARC LENGTH OF 30.46 FEET, A CHORD BEARING OF S79°58'04"E, AND A CHORD LENGTH OF 29.88 FEET TO A POINT; THENCE S60°34'42"E, 92.22 FEET ALONG SAID CENTERLINE TO A POINT; THENCE N74°40'47"E, 66.42 FEET ALONG SAID CENTERLINE TO A POINT; THENCE S71°47'10"E, 126.00 FEET ALONG SAID CENTERLINE TO A POINT; THENCE S83°25'57"E, 205.00 FEET ALONG SAID CENTERLINE TO A POINT; THENCE S61°27'11"E, 85.00 FEET ALONG SAID CENTERLINE TO A POINT; THENCE S86°34'04"E, 16.00 FEET ALONG SAID CENTERLINE TO A POINT; THENCE N69°46'51"E, 35.73 FEET ALONG SAID CENTERLINE TO A POINT; THENCE, ALONG SAID CENTERLINE THROUGH A CURVE TO THE RIGHT, HAVING A CENTRAL ANGLE OF 95°16'24", A RADIUS OF 10.00 FEET, AN ARC LENGTH OF 14.78 FEET, A CHORD BEARING OF S62°54'55"E, AND A CHORD LENGTH OF 14.78 FEET TO A POINT; THENCE S14°56'45"E, 53.48 FEET ALONG SAID CENTERLINE TO A POINT; THENCE, ALONG SAID CENTERLINE THROUGH A CURVE TO THE LEFT, HAVING A CENTRAL ANGLE OF 58°58'11", A RADIUS OF 20.00 FEET, AN ARC LENGTH OF 20.58 FEET, A CHORD BEARING OF S44°25'50"E, AND A CHORD LENGTH OF 19.69 FEET TO A POINT; THENCE S73°54'55"E, 20.24 FEET ALONG SAID CENTERLINE TO A POINT; THENCE, ALONG SAID CENTERLINE THROUGH A REVERSE CURVE TO THE LEFT, HAVING A CENTRAL ANGLE OF 70°03'42", A RADIUS OF 20.00 FEET, AN ARC LENGTH OF 24.46 FEET, A CHORD BEARING OF N71°03'14"E, AND A CHORD LENGTH OF 22.96 FEET TO A POINT; THENCE, ALONG SAID CENTERLINE THROUGH A REVERSE CURVE TO THE RIGHT, HAVING A CENTRAL ANGLE OF 50°14'44", A RADIUS OF 60.00 FEET, AN ARC LENGTH OF 52.62 FEET, A CHORD BEARING OF N51°08'45"E, AND A CHORD LENGTH OF 50.95 FEET TO A POINT; SAID POINT LYING ON THE EAST LINE OF SAID SE1/4; THENCE S00°12'32"E, 318.00 FEET ALONG SAID EAST LINE OF THE SE1/4 TO THE POINT OF BEGINNING OF SAID TRACT.

SAID TRACT CONTAINS 5.05 ACRES OF LAND, MORE OR LESS.

PARCEL 2

A TRACT OF LAND SITUATED IN THE SE1/4 OF SECTION 17, TOWNSHIP 56 NORTH, RANGE 84 WEST, 6TH P.M., SHERIDAN COUNTY, WYOMING; SAID TRACT OF LAND BEING MORE PARTICULARLY DESCRIBED AS FOLLOWS:

COMMENCING AT THE SOUTHEAST CORNER OF SAID SECTION 17 (MONUMENTED WITH A MILITARY MONUMENT MM-24); THENCE N00°19'32"E, 318.00 FEET ALONG THE EAST LINE OF SAID SE1/4 TO THE POINT OF BEGINNING OF SAID TRACT; SAID POINT LYING ON THE CENTERLINE OF SOLDIER CREEK; THENCE ALONG SAID CENTERLINE OF SOLDIER CREEK THROUGH A NON-TANGENT CURVE TO THE LEFT, HAVING A CENTRAL ANGLE OF 50°14'44", A RADIUS OF 60.00 FEET, AN ARC LENGTH OF 52.62 FEET, A CHORD BEARING OF S61°08'45"W, AND A CHORD LENGTH OF 50.95 FEET TO A POINT; THENCE, ALONG SAID CENTERLINE THROUGH A REVERSE CURVE TO THE RIGHT, HAVING A CENTRAL ANGLE OF 70°03'42", A RADIUS OF 20.00 FEET, AN ARC LENGTH OF 24.46 FEET, A CHORD BEARING OF S71°03'14"W, AND A CHORD LENGTH OF 22.96 FEET TO A POINT; THENCE N73°54'55"W, 20.24 FEET ALONG SAID CENTERLINE TO A POINT; THENCE, ALONG SAID CENTERLINE THROUGH A CURVE TO THE RIGHT, HAVING A CENTRAL ANGLE OF 58°58'11", A RADIUS OF 20.00 FEET, AN ARC LENGTH OF 20.58 FEET, A CHORD BEARING OF N44°25'50"W, AND A CHORD LENGTH OF 19.69 FEET TO A POINT; THENCE N14°56'45"W, 53.48 FEET ALONG SAID CENTERLINE TO A POINT; THENCE, ALONG SAID CENTERLINE THROUGH A CURVE TO THE LEFT, HAVING A CENTRAL ANGLE OF 95°16'24", A RADIUS OF 10.00 FEET, AN ARC LENGTH OF 14.78 FEET, A CHORD BEARING OF N62°34'57"W, AND A CHORD LENGTH OF 14.78 FEET TO A POINT; THENCE S89°46'51"W, 35.73 FEET ALONG SAID CENTERLINE TO A POINT; THENCE N86°34'04"W, 16.00 FEET ALONG SAID CENTERLINE TO A POINT; THENCE N61°27'11"W, 85.00 FEET ALONG SAID CENTERLINE TO A POINT; THENCE N83°25'57"W, 205.00 FEET ALONG SAID CENTERLINE TO A POINT; THENCE N71°47'10"W, 126.00 FEET ALONG SAID CENTERLINE TO A POINT; THENCE S74°40'47"W, 66.42 FEET ALONG SAID CENTERLINE TO A POINT; THENCE N60°34'42"W, 92.22 FEET ALONG SAID CENTERLINE TO A POINT; THENCE N74°40'47"E, 66.42 FEET ALONG SAID CENTERLINE THROUGH A CURVE TO THE LEFT, HAVING A CENTRAL ANGLE OF 38°46'45", A RADIUS OF 45.00 FEET, AN ARC LENGTH OF 30.46 FEET, A CHORD BEARING OF N79°58'04"W, AND A CHORD LENGTH OF 29.88 FEET TO A POINT; THENCE, ALONG SAID CENTERLINE THROUGH A REVERSE CURVE TO THE RIGHT, HAVING A CENTRAL ANGLE OF 81°25'54", A RADIUS OF 30.00 FEET, AN ARC LENGTH OF 42.64 FEET, A CHORD BEARING OF N58°38'30"W, AND A CHORD LENGTH OF 39.14 FEET TO A POINT; THENCE N17°55'33"W, 57.00 FEET ALONG SAID CENTERLINE TO A POINT; THENCE N29°39'48"W, 21.01 FEET ALONG SAID CENTERLINE TO A POINT; THENCE N09°13'46"W, 32.62 FEET ALONG SAID CENTERLINE TO A POINT; THENCE, ALONG SAID CENTERLINE THROUGH A CURVE TO THE LEFT, HAVING A CENTRAL ANGLE OF 78°57'21", A RADIUS OF 10.00 FEET, AN ARC LENGTH OF 13.78 FEET, A CHORD BEARING OF N48°42'26"W, AND A CHORD LENGTH OF 12.72 FEET TO A POINT; THENCE, LEAVING SAID CENTERLINE OF SOLDIER CREEK, S10°08'14"W, 295.75 FEET TO A POINT, SAID POINT LYING ON THE NORTH LINE OF A TRACT OF LAND DESCRIBED IN BOOK 441 OF DEEDS, PAGE 350; THENCE N73°36'19"W, 388.62 FEET ALONG SAID NORTH LINE OF SAID TRACT TO A POINT (MONUMENTED WITH A 1 1/2" ALUMINUM CAP PER PLS 2615); THENCE N16°15'55"E, 14.42 FEET ALONG SAID NORTH LINE TO A POINT (MONUMENTED WITH A 1 1/2" ALUMINUM CAP PER PLS 2615); THENCE N74°25'03"W, 128.48 FEET ALONG SAID NORTH LINE TO A POINT (MONUMENTED WITH A 1 1/2" ALUMINUM CAP PER PLS 2615); SAID POINT BEING THE NORTHEAST CORNER OF SAID TRACT DESCRIBED IN BOOK 441 OF DEEDS, PAGE 350; THENCE, CONTINUE N74°25'03"W, 14.25 FEET TO A POINT, SAID POINT LYING ON THE EAST LINE OF TRACT 1, CERTIFICATE OF SURVEY FILED IN DRAWER "A" OF PLATS, NUMBER "438"; THENCE N00°23'19"W, 331.01 FEET ALONG THE EAST LINE OF SAID TRACT 1 TO A POINT, SAID POINT BEING THE SOUTHEAST CORNER OF TRACT 5, CERTIFICATE OF SURVEY FILED IN DRAWER "A" OF PLATS, NUMBER "438" (MONUMENTED WITH A 2" ALUMINUM CAP PER PLS 3864); THENCE, N00°23'54"W, 589.76 FEET ALONG SAID TRACT 5 TO A POINT, SAID POINT BEING THE NORTHEAST CORNER OF SAID TRACT 5 (MONUMENTED WITH A 2" ALUMINUM CAP PER PLS 3864); THENCE S87°31'41"E, 1364.84 FEET ALONG THE NORTH LINE OF THE SE1/4 TO A POINT, SAID POINT BEING THE NORTHEAST CORNER OF SAID SE1/4 (MONUMENTED WITH A MILITARY MONUMENT MM-25); THENCE S00°19'32"E, 1031.56 FEET ALONG SAID EAST LINE OF SAID SE1/4 TO THE POINT OF BEGINNING OF SAID TRACT.

SAID TRACT CONTAINS 30.21 ACRES OF LAND, MORE OR LESS.

TOWNSHIP 56 NORTH RANGE 84 WEST

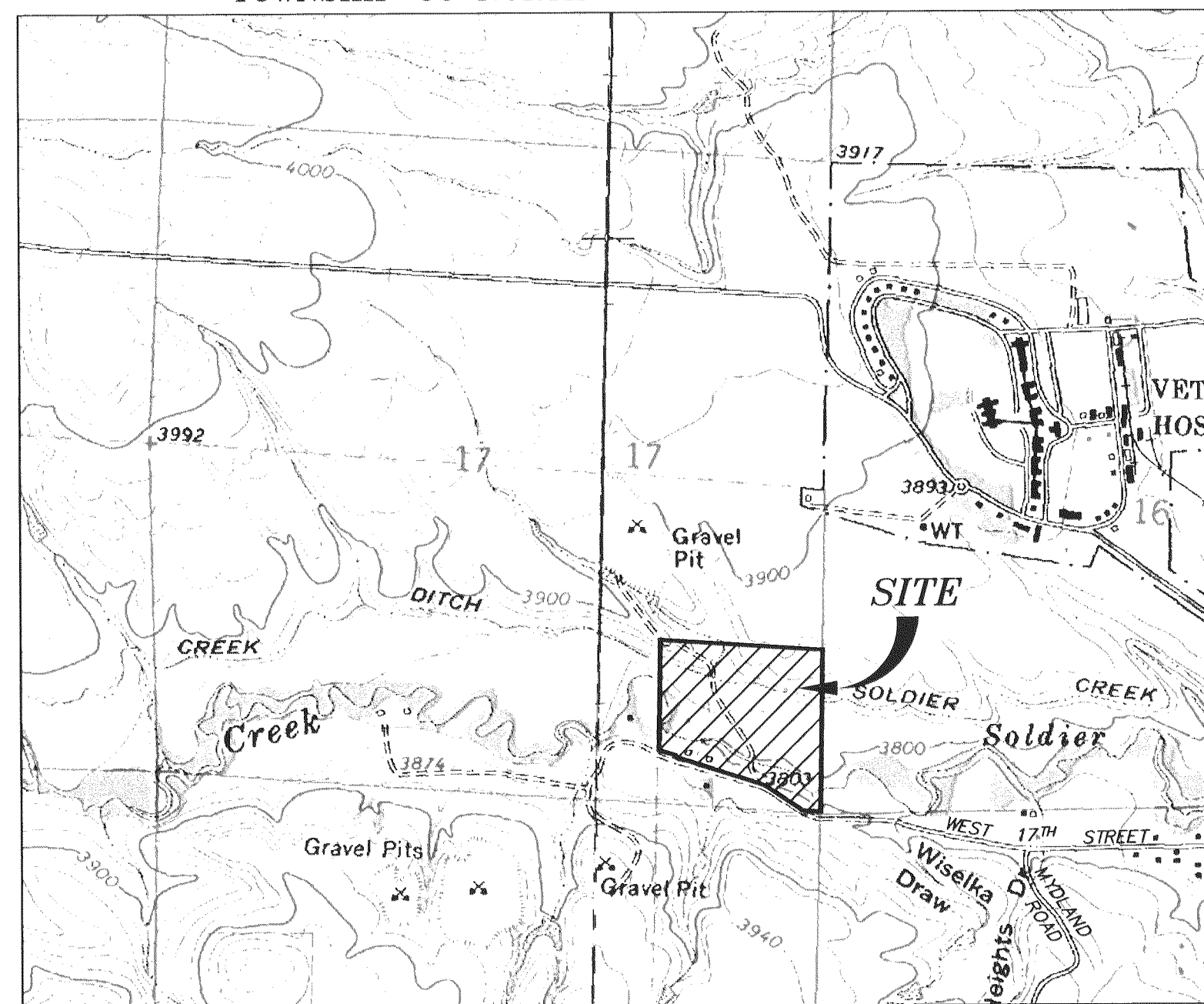

LOCATION MAP
NO TRUE SCALE

NOTICE
This plat is an image or reproduction of the original as is recorded in the
Sheridan County Clerk's Office. It is not a title, complete or
authoritative depiction of current property lines, easements or rights-of-
way. Delineations, measurement or representations may have occurred
since the original plat was recorded.



SCALE: 1"=100'
BEARINGS ARE BASED ON THE
WYOMING COORDINATE SYSTEM NAD 1983, EAST CENTRAL ZONE
DISTANCES ARE SURFACE

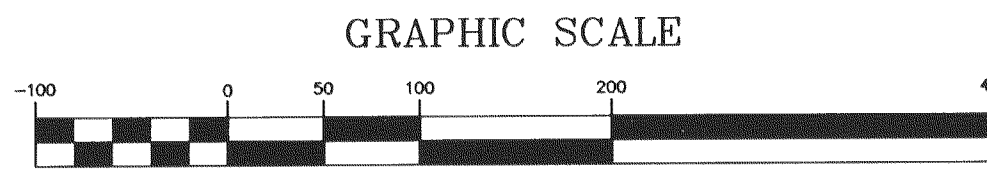

(U.S. SURVEY FEET)
1 inch = 100 ft.

DATUM:

NAD 83(1983), NAVD 88 (U.S. SURVEY FEET)
DATUM ADJUSTMENT FACTOR (DAF): 1.000235
DIVIDE SURFACE COORDINATES BY DAF TO CALCULATE
THE WYOMING COORDINATE SYSTEM NAD 1983,
EAST CENTRAL ZONE, COORDINATES

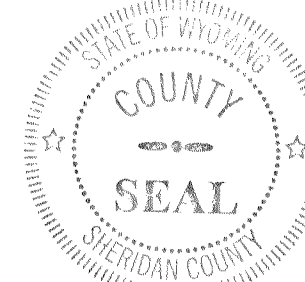

CERTIFICATE OF RECORDER

STATE OF WYOMING) ss
COUNTY OF SHERIDAN)

THIS PLAT WAS FILED FOR RECORD IN THE OFFICE OF THE CLERK AND RECORDER AT 4:15 O'CLOCK P.M.,
THIS 9, DAY OF APRIL, 2012, AND IS DULY RECORDED IN DRAWER A, PLAT NO. 445
FEE \$25.00

Eda Schunk Thompson
COUNTY CLERK

STAMP RECEIVING NUMBER 2012-695486

SURVEYOR'S CERTIFICATE

STATE OF WYOMING) ss
COUNTY OF SHERIDAN)

I, THOMAS D. TUCKER, A DULY REGISTERED LAND SURVEYOR IN THE STATE OF
WYOMING, DO HEREBY STATE THAT THIS PLAT REPRESENTS THE RESULTS OF
A SURVEY MADE BY ME OR UNDER MY DIRECT SUPERVISION.

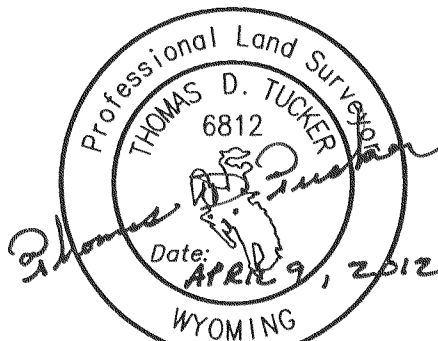

"PLAT IS VALID ONLY IF PRINT HAS
ORIGINAL SIGNATURE OF SURVEYOR SIGNED AND DATED"

RECORD OF SURVEY FOR BOUNDARY LINE ADJUSTMENT

CLIENT: WADE T. TRAPHAGEN
LOCATION: SE1/4 OF SECTION 17, TOWNSHIP 56 NORTH, RANGE
84 WEST, 6TH P.M., SHERIDAN COUNTY, WYOMING.

RESTFELDT
SURVEYING
P.O. BOX 4001
2809 W. 17TH STREET
SHERIDAN, WY 82801
307-672-7415
FAX 374-5000

LEATHA M. TRAPHAGEN
P.O. BOX 4001
2809 W. 17TH STREET
SHERIDAN, WY 82801

JN: 2011-092
DF: 20110920
PF: 12011092
APRIL 9, 2012

#445