

Initialed For Identification *RS* *JD*  
*JK*

POWDER RIVER ENERGY CORPORATION  
SUNDANCE, WYOMING  
Right Of Way Easement

KNOW ALL MEN BY THESE PRESENTS:

That (I) (We) the undersigned: Verlin and Karen J. Dannar

With an address of: PO Box 350 Sheridan, WY 82801

for a good and valuable consideration, the receipt whereof is hereby acknowledged, do hereby grant unto Powder River Energy Corporation, a cooperative corporation (hereinafter called the Cooperative) whose corporate headquarters post office address is Sundance, Wyoming and to its successors and assigns an easement 30 feet in width along with the right to enter upon the hereinafter described lands and to construct thereon, operate, change framing and voltage and maintain electric lines and associated facilities and equipment and to cut and trim trees and shrubbery that may interfere with or threaten to endanger the operations and maintenance of said lines, facilities and equipment, including the right of ingress and egress to and from said lands, to wit:

T57N, R82W, 6<sup>th</sup> P.M., Sheridan County, Wyoming      T58N, R82W, 6<sup>th</sup> P.M., Sheridan County, Wyoming

Section 4:      W1/2  
Section 5:      SE1/4NE1/4  
Section 8:      NE1/4SE1/4

Section 32:      SE1/4SE1/4, NW1/4SE1/4

as shown on the attached map marked "Exhibit A".

The undersigned agree that all poles, wire and other facilities and equipment installed at the Cooperative's expense on said described lands shall be and remain the property of the cooperative, removable at the option of the cooperative upon the termination of services to, or through said lands.

The undersigned covenant that they are the owners of the above described land and that said lands are free and clear of encumbrances and liens of whatsoever character except those held by the following described persons:

Hereby releasing and waiving all rights under and by virtue of the homestead exemption laws of the State of Wyoming.

IN WITNESS WHEREOF, the undersigned have set their hands this \_\_\_\_ day of \_\_\_\_\_, 2006

*Verlin Dannar*  
name Verlin Dannar

*Karen J. Dannar*  
name Karen J. Dannar

State of Wyoming )  
County of Sheridan )ss

State of Wyoming )  
County of Sheridan )ss

The foregoing instrument was acknowledged before me  
this 17<sup>th</sup> day of February, 2006  
by Verlin Dannar

The foregoing instrument was acknowledged before me  
this 17<sup>th</sup> day of February, 2006  
by Karen J. Dannar

Witness my hand official seal *Carol M. Wisenbaker*  
Notary Public  
My commission expires: 9-5-07

Witness my hand official seal *Carol M. Wisenbaker*  
Notary Public  
My commission expires: 9-5-07

WO 50622  
57398



365

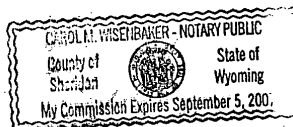

## Danner Easement

T57N, R82W, 6<sup>th</sup> P.M., Sheridan County, Wyoming      T58N, R82W, 6<sup>th</sup> P.M., Sheridan County, Wyoming

Section 4: W1/2  
 Section 5: SE1/4NE1/4  
 Section 8: NE1/4SE1/4

Section 32: SE1/4SE1/4, NW1/4SE1/4

Beginning at a point on the South line of the NE1/4SE1/4 of said Section 8, from which the NE corner of said Section 5 bears North 02°45'28" East, a distance of 9249.75 feet (POINT OF BEGINNING #1); thence along the centerline of an easement, the bearings and distances of which are approximate, North 28°30'03" West, a distance of 120.16 feet; thence North 08°07'08" East, a distance of 229.20 feet to the POINT OF TERMINUS #1, being a point in the NE1/4SE1/4 of said Section 8.

AND beginning at a point in the SE1/4SW1/4 of said Section 4, from which the NE corner of said Section 5 bears North 19°31'43" West, a distance of 4678.92 feet (POINT OF BEGINNING #2); thence along the centerline of an easement, the bearings and distances of which are approximate, North 38°11'03" West, a distance of 7.42 feet; thence North 03°39'25" West, a distance of 1281.42 feet; thence North 29°28'26" West, a distance of 674.14 feet; thence North 45°59'47" West, a distance of 102.62 feet; thence North 69°44'35" West, a distance of 1164.80 feet to the beginning of "Tap A". Thence North 69°44'35" West, a distance of 43.00 feet to the end of said "Tap A", being a point in the SE1/4NE1/4 of said Section 5. Thence continuing North 05°24'37" East, a distance of 1935.46 feet; thence North 19°57'47" West, a distance of 36.44 feet; thence North 45°20'12" West, a distance of 445.26 feet; thence North 56°36'07" West, a distance of 74.54 feet; thence North 67°52'03" West, a distance of 457.12 feet; thence North 32°28'42" West, a distance of 1295.63 feet; thence North 02°20'50" East, a distance of 1241.55 feet to the POINT OF TERMINUS #2, being a point in the SE1/4NE1/4 of said Section 15.

The above description is for a three-phase 24.9/14.4kV overhead power line "Right-of-Way", 30' in width, being 15' on either side of centerline extending an approximate total distance of 9108.74 feet, including but not limited to any and all meter poles, anchors and guy structures that are affixed to the powerline and located by necessity outside of the herein described 30 foot right-of-way corridor.

☒ is for single-phase 480V or 120V transformer/meter (to be provided by Pennaco/Marathon).

In paragraph 1 above, please note that we have added the following:

The Point of Terminus meter pole will be on the North side of the existing fence.

*Verlin Danner*  
 Verlin Danner

*Karen J. Danner*  
 Karen J. Danner

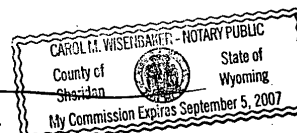

Witnessed by: *Tim Sheehan*  
 Tim Sheehan

*Carol M. Wisenbaker*  
 Carol M. Wisenbaker

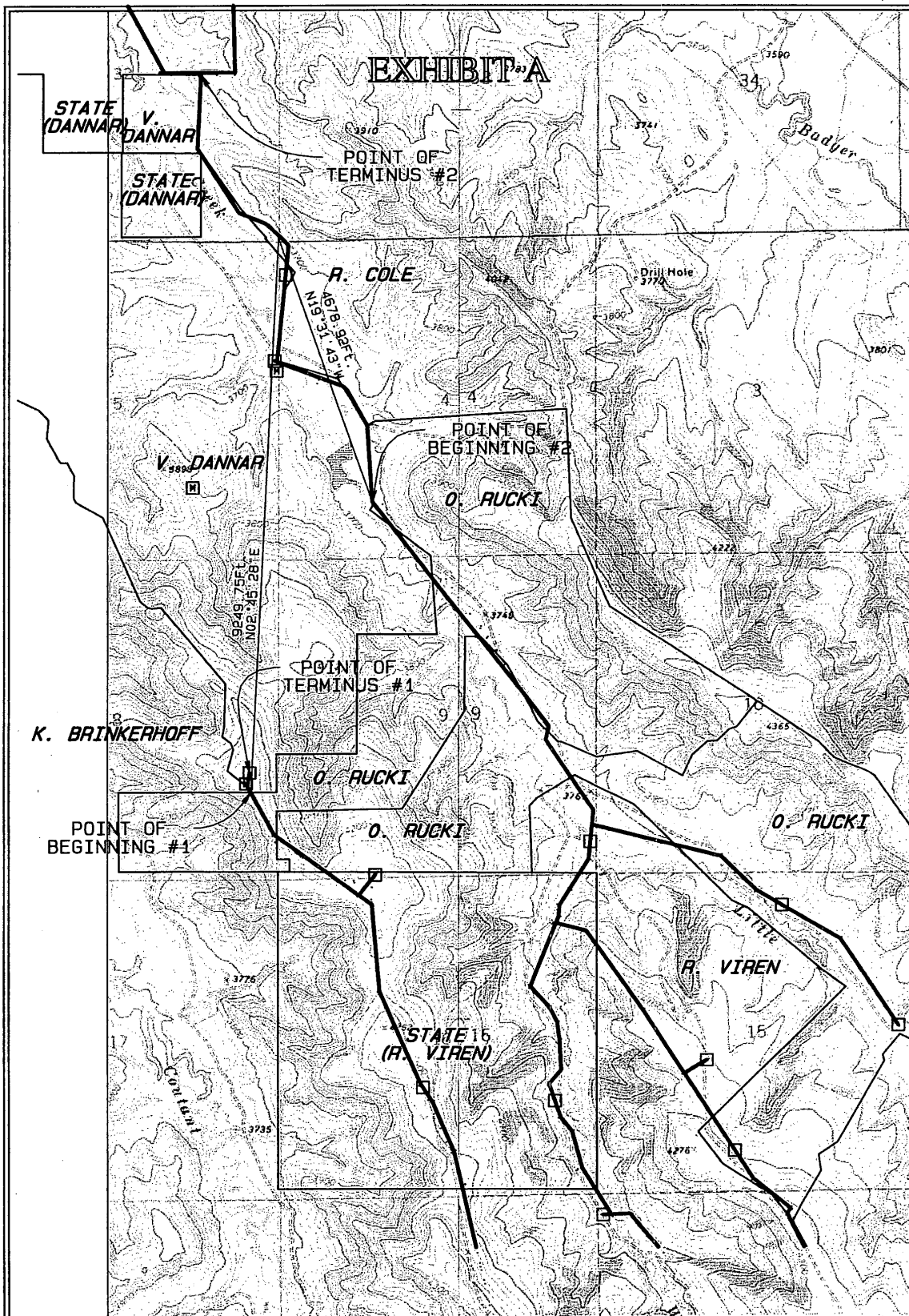

Map created with TOPO!® ©2003 National Geographic (www.nationalgeographic.com/topo)



Basis of Bearings: ASTRONOMIC  
(using Static/RTK GPS methods)

# LEGEND

□ POWER DROP

367

DRAWING FILE: DANNAR  
DATE: 12/27/05

MEAS'D BY: R. SCHUETZ  
DRAWN BY: R. MILLER  
CHECKED BY: R. SCHUETZ

NO #: 50622  
SCALE: 1" = 2000'

PAGE 3 OF 3