

STATE OF WYOMING     )  
                                      ) ss.  
County of Sheridan     )

569909 AFFIDAVIT  
BOOK 484 PAGE 0213  
RECORDED 04/04/2007 AT 03:15 PM  
AUDREY KOLTISKA, SHERIDAN COUNTY CLERK

**AFFIDAVIT REGARDING TEMPORARY ACCESS  
AND CONSTRUCTION EASEMENT**

I, Clint A. Langer, being first duly sworn upon oath, hereby state as follows:

1. This Affidavit is made pursuant to Wyo: Stat. Ann. § 34-11-101.
2. I am a partner with the firm of Davis & Cannon, which represents the Mead Creek Ditch Company Irrigation District ("District").
3. On behalf of the Mead Creek Ditch Company Irrigation District, I filed a Temporary Access and Construction Easement ("Easement") granted by Elwin Webb Phillips and James Reed Phillips to the District, dated February 8, 2007 and recorded on February 8, 2007 in Book 481, Page 0678 in the land records of the Sheridan County Clerk.
4. Due to a clerical error, the Easement failed to include a section number.

The complete legal description that should have been included in the Easement is as follows:

SW¼, Section 4, T53N, R83W  
SE¼, Section 5, T53N, R83W  
NE¼, NW¼, SW¼, Section 8, T53N, R83W

5. In addition, the Easement references an Exhibit A, which was erroneously excluded from the document that was recorded in the land records of the Sheridan County Clerk. The Exhibit A, which is referenced in the Easement, is attached to this Affidavit.

Further, affiant saith not this 28<sup>th</sup> day of March, 2007.

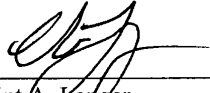
  
\_\_\_\_\_  
Clint A. Langer  
Davis & Cannon  
Attorneys at Law  
40 South Main Street  
P.O. Box 728  
Sheridan, Wyoming 82801  
(307) 672-7491  
(307) 672-8955 facsimile

Subscribed and sworn to before me this 28<sup>th</sup> day of March, 2007 by Clint A. Langer.

WITNESS my hand and official seal.

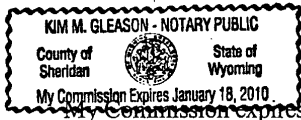

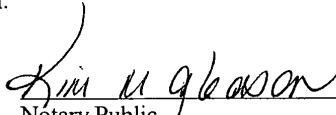
  
\_\_\_\_\_  
Kim M. Gleason  
Notary Public

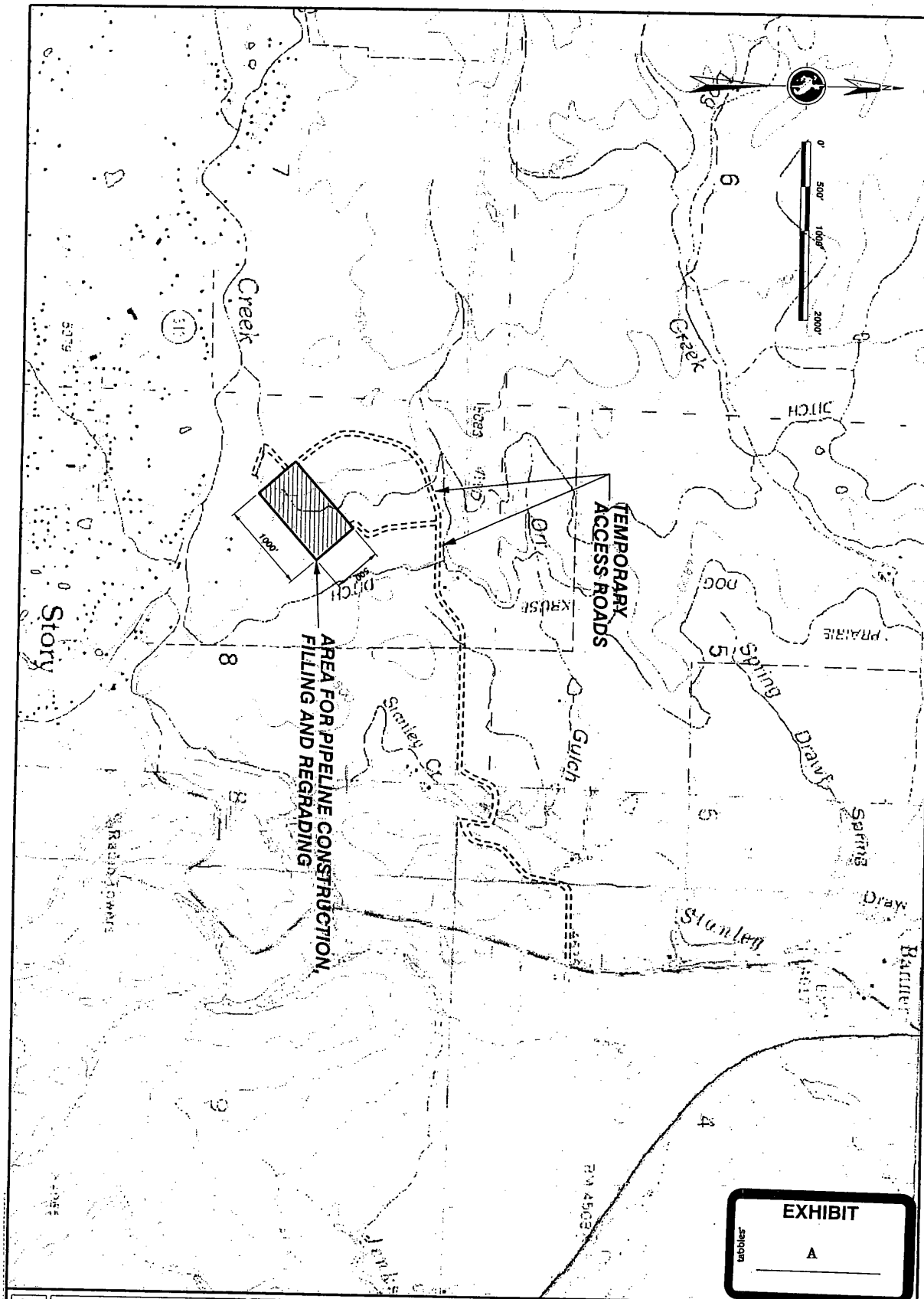

**EXHIBIT**  
A

**EXHIBIT A**  
**EnTech, Inc.**  
Professional Engineers  
Transportation - Municipal - Environmental - Water Resources  
1840 Supercenter Drive, Suite 205  
Shenandoah, Wyoming 82801  
Phone 307-873-1542  
Fax 307-873-1547  
E-mail entech@entechusa.net

**MEADE CREEK  
DITCH IRRIGATION  
DISTRICT DROP  
STRUCTURE PROJECT**

**LOCATION OF TEMPORARY  
ACCESS AND  
CONSTRUCTION EASEMENT**

DESIGN	NO.	AMENDMENT	DATE	INT.
CAL				
CHECK				
DTE				
DATE				
1/07				

PROJECT NO. 06002