



2019-753275 10/10/2019 12:15 PM PAGE: 1 OF 3  
 BOOK: 583 PAGE: 590 FEES: \$18.00 PK EASEMENT  
 EDA SCHUNK THOMPSON, SHERIDAN COUNTY CLERK

**MEMORANDUM OF EASEMENT AND  
 RIGHT-OF-WAY AGREEMENT**

WO# 190625 / 107.20

TO WHOM IT MAY CONCERN:

Please take notice **Daniel A. Bell, a single person** (Grantor) has entered into an Easement and Right-of-Way Agreement with Powder River Energy Corporation (PRECorp), a Wyoming cooperative utility (Grantee).

The legal description of the centerline of the easement and property affected is attached hereto and marked as Exhibit A. Any third party who desires to know the terms and conditions of the Easement and Right-of-Way Agreement may direct a request to Grantor and Grantor shall be free to divulge any and all information associated with the Easement and Right-of-Way Agreement between Grantor and Grantee.

Any requests for information may be sent to Grantor at the following address:

**Daniel A. Bell**  
**1357 Dana Ave**  
**Sheridan, WY 82801-2403**

IN WITNESS WHEREOF, Grantor has executed this Agreement as of the 24 day of September, 2019.

**GRANTOR:**

Print: Daniel A. Bell

Sign: *Daniel A. Bell*

STATE OF Wyoming )  
 ) ss.  
 COUNTY OF Sheridan

On this the 24 day of September, 2019, before me, the undersigned officer, personally appeared **Daniel A. Bell, a single person**, known to me or satisfactorily proven to be the person whose name is subscribed to the within instrument and acknowledged that s/he executed the same for the purposes therein contained.

IN WITNESS WHEREOF, I hereunto set my hand and official seal.  
 (SEAL)

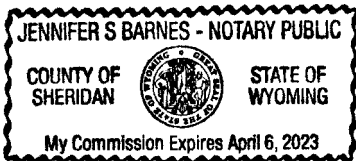

*J. Barnes*  
 Notary Public

My Commission Expires: April 6, 2023



2019-753275 10/10/2019 12:15 PM PAGE: 2 OF 3  
BOOK: 583 PAGE: 591 FEES: \$18.00 PK EASEMENT  
EDA SCHUNK THOMPSON, SHERIDAN COUNTY CLERK

IN WITNESS WHEREOF, Grantee has executed this Agreement as of the 27 day  
of September, 2019.

**GRANTEE:**

Print: Powder River Energy Corporation

Sign: Angela Sabus

Land Services Agent

STATE OF Wyoming )

COUNTY OF Campbell ) ss.

On this the 27 day of September, 2019, before me, the undersigned  
officer, personally appeared Angela Sabus Land Services Agent for Powder  
River Energy Corporation, known to me or satisfactorily proven to be the person whose  
name is subscribed to the within instrument and acknowledged that s/he executed the  
same for the purposes therein contained.

IN WITNESS WHEREOF, I hereunto set my hand and official seal.  
(SEAL)

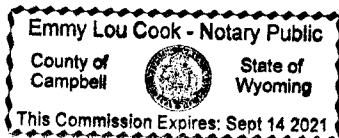

[Signature]  
Notary Public

My Commission Expires: Sept 14 2021



2019-753275 10/10/2019 12:15 PM PAGE: 3 OF 3  
BOOK: 583 PAGE: 592 FEES: \$18.00 PK EASEMENT  
EDA SCHUNK THOMPSON, SHERIDAN COUNTY CLERK



# "Exhibit A"

## Bell

Page 1 of 1  
By and Between  
Bell and Powder  
River Energy Corp  
Initials DB

T55N, R82W, 6th P.M., Sheridan County, Wyoming  
Section 29: NESE

WO#: 190625

Bearing and distances are approximated based on GPS data gathered and projected into  
NAD 83 Wyoming State Plane, East Central Zone, US Survey feet.

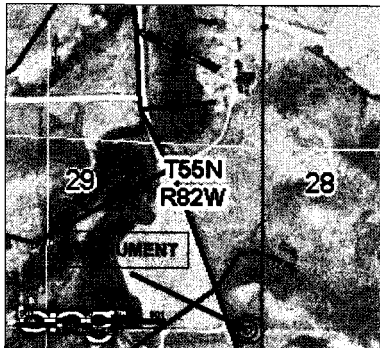

An easement 30 Feet in width, being 15 Feet on each side of the following described line. Commencing at the Southeast Corner of Section 29, T55N, R82W, thence  $N20^{\circ}26'20.308''W$  a distance of 1950 Feet, more or less, to the POINT OF BEGINNING; thence  $S65^{\circ}2'36.675''E$  a distance of 531 Feet, more or less, thus to the ending point.

The above described is for power line ROW extending a total of 531 feet, more or less.

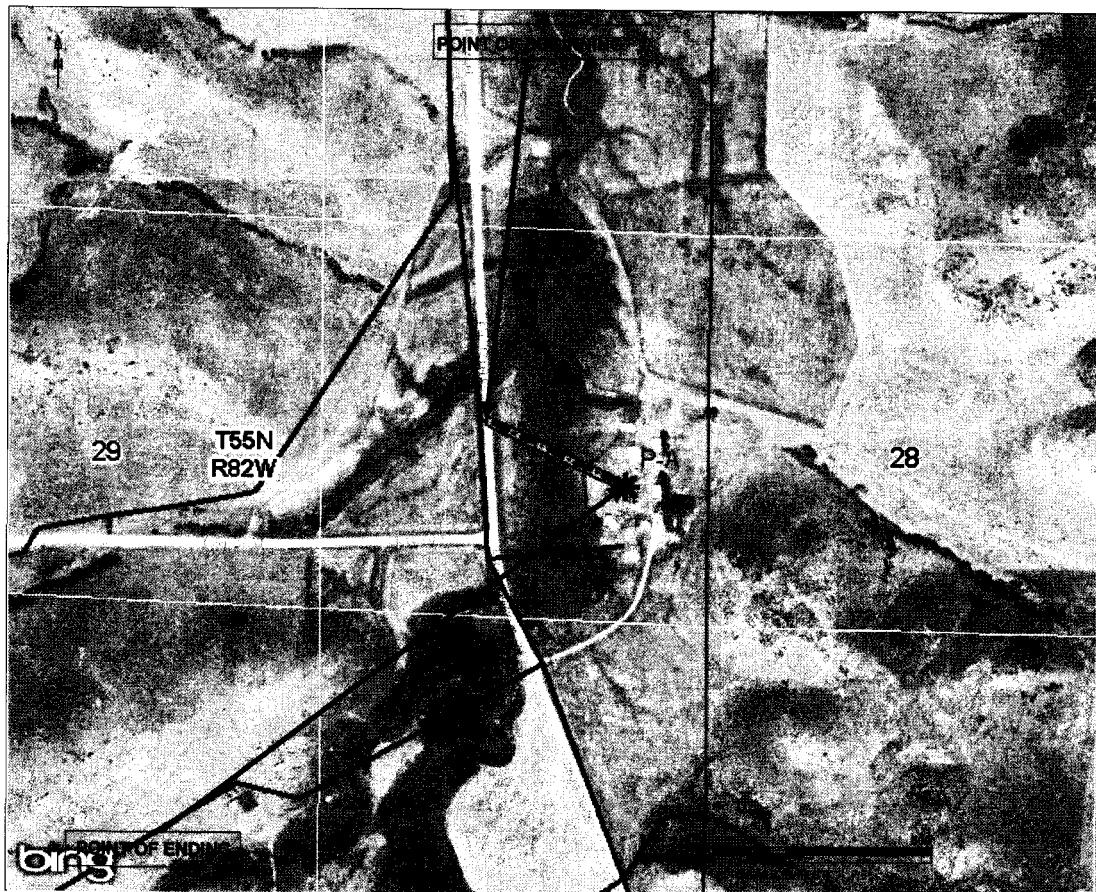

Point P-A is set at the center of a circular tract of land with a radius of 40 feet.

09/17/2019

### NO. 2019-753275 EASEMENT

EDA SCHUNK THOMPSON, SHERIDAN COUNTY CLERK  
POWDER RIVER ENERGY CORP P O BOX 930  
SUNDANCE WY 82729