

RECORDED JULY 6, 1992 BK 351 PG 549 NO 113905 RONALD L. DAILEY, COUNTY CLERK
EASEMENT

KNOW ALL MEN BY THESE PRESENTS, that we, the undersigned, (whether one or more) _____
Regina Leath

(undersigned) _____ of _____ County, State of _____, for a good and valuable consideration, the receipt whereof is hereby acknowledged, do hereby convey and warrant unto Sheridan-Johnson Rural Electrification Association, a Wyoming corporation, whose post office address is Sheridan, Sheridan County, Wyoming, and to its successors or assigns, the right to enter upon the lands hereinafter described, situated in the County of _____, State of _____, and more particularly described as follows, to-wit:

SESE, NESE, NWSE, SENW Section 25, T54N, R83W, Sheridan County, Wyoming

See attached Exhibit "A" for an approximate location of centerline and detailed description.

The undersigned hereby relinquish(es), release(s) and waive(s) all rights, distributive shares or homestead interest under and by virtue of the homestead exemption laws of the State of _____ to the extent necessary to permit the Association the free enjoyment of the rights herein conferred; and to place, construct, operate, repair, maintain, relocate and replace thereon and/or construct, maintain, operate, repair, relocate and replace underground an electrical transmission or distribution line or system for the purpose of conveying electricity over, across, through, and under the lands herein above described together with the rights to excavate and refill ditches and trenches for the location of said line or system, and further to include in addition thereto such rights upon all streets, roads, and highways abutting said land, and to license, permit or otherwise agree to the joint use or occupancy of the line or system by any other person, association, or corporation for electrification or telephone purposes, and the further right to trim, cut, and remove trees, shrubbery, undergrowth, and other obstacles interfering with the location, construction, and maintenance of said line or system.

In granting this easement it is understood that the location of utility poles necessary to span the above described land overhead will be such as to form the least possible interference to farm operations, so long as it does not materially increase the cost of construction.

The undersigned agree(s) that all utility poles, wires, and other facilities, including any main service entrance equipment, installed on the above described lands at the Association's expense shall remain the property of the Association, removable at the option of the Association, upon termination of service to, on, or through said lands.

The undersigned covenant(s) that he (or they) is (or are) the owner(s) of the above described lands and that said lands are free and clear of encumbrances and liens of whatsoever character except those held by the following persons:

It is further understood that whenever necessary, the words used in this instrument in the singular shall be construed to read in the plural and that words used in the masculine gender shall be construed to read in the feminine.

IN WITNESS WHEREOF, the undersigned has (have) his (or their) hand(s) and seal(s) this _____ day of _____

A. D., 19____

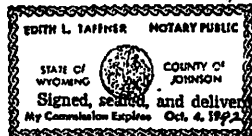

Signed, sealed, and delivered in the presence of:

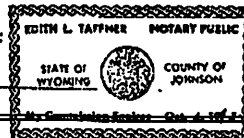

STATE OF _____
COUNTY OF _____ ss.

On this _____ day of _____, 19____, before me personally appeared _____
to me known to be the person _____ described in and who executed the foregoing instrument and acknowledged that _____

executed the same as _____ free act and deed, including the release and waiver of the right of homestead, the said wife have been by me fully apprised of her right and the effect of signing and acknowledging the said instrument.

My commission expires on the _____ day of _____, 19____

NOTE

The acknowledgment set forth above is for individuals; the following form is to be used for corporations:

STATE OF _____
COUNTY OF _____ ss.

On this _____ day of _____, 19____, before me personally appeared _____
to me personally known, who, having been by me first duly sworn did say: That he is the _____ of _____
the Corporation described in and which executed the foregoing instrument; that the seal affixed to said instrument is the corporate seal of said Corporation; and that said instrument was signed and sealed in behalf of said Corporation by authority of its Board of Directors; and said _____ acknowledged said instrument to be the free and voluntary act and deed of said Corporation.

In Witness Whereof I have hereunto set my hand and affixed my notarial seal on the day and year in this certificate first above written.

My commission expires on the _____ day of _____, 19____

Notary Public

549

QUICK PRINT, SHERIDAN

550
EXHIBIT 'A'

LEATH

Page 2 of 2

By and Between Regina Leath
and Sheridan-Johnson Rural
Electrification Association

(Initialed for Identification) *RL*

Beginning at the SE corner of Section 25, T54N., R83W., Sheridan County, Wyoming; thence bearing approximately North along the eastern boundary of Section 25 approximately 670' to a point where the new power line enters Leath property in mid span (Point of Ingress; and True Point of Beginning).

The new 1-phase power line continues routing on Leath property bearing approximately North 78°-25' West for an approximate distance of 355'; thence bearing approximately North 60°-56' West for an approximate distance of 600'; thence bearing approximately North 78°-43' West for an approximate distance of 550'; thence bearing approximately North 67°-56' West for an approximate distance of 1,725'; thence bearing approximately South 84°-01' West for an approximate distance of 751'; thence bearing approximately South 70°-50' West for an approximate distance of 211'; thence bearing approximately South 60°-10' East for an approximate distance of 144' to a point where the new 1-phase power line adjoins the existing 1-phase power line routed along Murphy Gulch (Point of Ending). This point being approximately 2,880' North and 3,010' West of the SE corner of Section 25, T54N., R82W., Sheridan County, Wyoming.

The above description is for a 1-phase 14.4KV overhead power line "Right-of-Way", 30' in width, being 15' either side of centerline, extending a total distance of 4,336' and containing 2.99 acres, more or less.

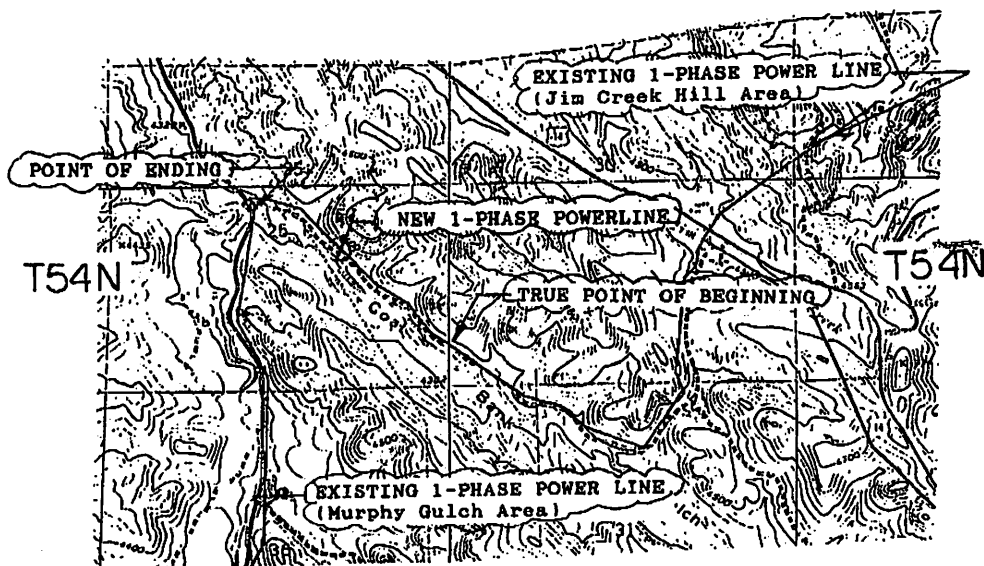

R83W | R82W

BANNER QUADRANGLE
WYOMING
7.5 MINUTE SERIES (TOPOGRAPHIC)