

Memorandum of Pipeline Easement

This memorandum is entered into by John E. Rice & Sons, Inc, a Wyoming corporation, whose address is 11 Lower Piney Creek Road, Banner, WY 82832, hereinafter called "Grantor," and Cedar Ridge LLC, whose address is 484 Turner Drive, Building B, Suite 3, Durango, CO 81303 hereinafter called "Grantee."

Grantor and Grantee entered into a Pipeline Easement dated December 4, 2007 which affects the following described land situate in Sheridan County, Wyoming:

Township 56 North, Range 84 West, 6th P.M.

Section 4: SW $\frac{1}{4}$

Section 5: SE $\frac{1}{4}$

Section 9: NW $\frac{1}{4}$

The proposed center line of the right-of-way is shown on the map which is attached as Exhibit A. The location of the pipeline crossing under Interstate 90 is subject to approval by the Wyoming Highway Department and may require relocation of the center line. Upon completion of the initial construction of the pipeline, and in any event within one year after the date of Pipeline Easement, Grantee shall provide Grantor with a survey of the center line of the pipeline.

Dated this 12 day of March, 2008.

Grantor:

John E. Rice & Sons, Inc.

By: 

President

Grantee:

Cedar Ridge LLC

By: 

Title: Manager

STATE OF WYOMING)
) ss.
 COUNTY OF SHERIDAN)

The foregoing instrument was acknowledged before me this 13th day of March, 2008, by Neltje, President of John E. Rice & Sons, Inc.

Witness my hand and official seal.

[Signature]
 Notary Public

My commission expires: 1-9-09



STATE OF Colorado)
) ss.
 COUNTY OF LaPlata)

The foregoing instrument was acknowledged before me this 17th day of March, 2008, by Terry L. Logan, Manager of Cedar Ridge LLC.

Witness my hand and official seal.

[Signature]
 Notary Public

My commission expires: Oct. 13, 2009



EXHIBIT
A

349

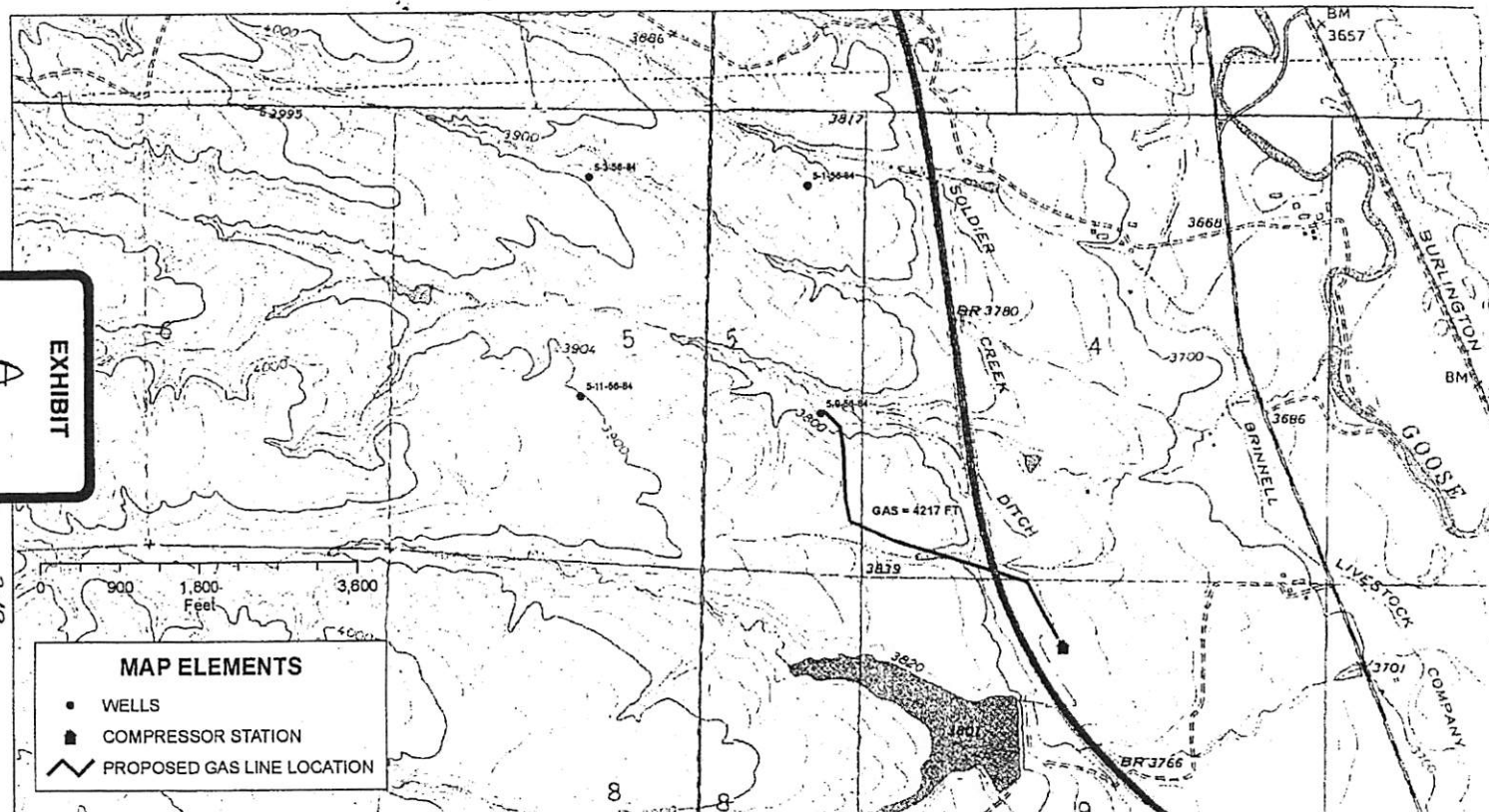

				PREPARED BY:		CLIENT:			
				Baker		CEDAR RIDGE LLC			
				A Unit of Michael Baker Corporation Sheridan Field Office 2286 North Main Street Sheridan, WY 82801 307-673-4888 Office		484 TURNER DRIVE BLDG. B, SUITE 3 DURANGO, COLORADO 81303 970.382.5980			
				DATA SET: H:\Common\WORKSPACE\CDR_RIDGE\SHERIDAN_CONSOLIDATED_CTY\Construction_Maps mssd\CDR_CHECK_INITIAL_LINER_CONSTRUCTION_LAYOUT_11x17.mxd		DESIGNER:		LANDMAN:	
				DATE: 11/26/2007		SCALE: 1" = 1000'		DRAWN: JAS	
				JOB PROJ CUST		DRAWING LOCATION: CONSTRUCTION MAPS\SOLDIER_CREEK_GAS_LINE_11x17_REV8_2007-11-26.PDF		REV: A	
				BY CHK		ENGR ENGR		APP	
				JAS		RR/TL			
				11/25/07		LINE COLOR CHANGED TO DARK GREEN LENGTH LISTED AS 4217 FT.			
				11/20/07		ISSUED FOR INFORMATION			
				REV		DATE		REVISIONS	

SOLDIER CREEK
GAS LINE TO BITTER CREEK COMPRESSOR
T56N, R84W, SECTIONS 4, 5 & 9
SHERIDAN COUNTY, WYOMING