

| Curve Table | | | | | |
|-------------|----------|---------|-----------|---------------|--------------|
| Curve No. | Radius | Length | Delta | Chord Bearing | Chord Length |
| C1 | 3650.00' | 275.54' | 4°19'31" | S63°29'28"E | 275.47' |
| C2 | 2250.00' | 528.55' | 13°27'34" | S54°35'55"E | 527.34' |
| C3 | 2890.00' | 108.14' | 2°08'38" | S46°47'49"E | 108.13' |
| C4 | 300.00' | 252.30' | 48°11'09" | S69°49'04"E | 244.93' |
| C5 | 820.00' | 398.42' | 27°50'19" | N72°10'14"E | 394.51' |

| Line Table | | |
|------------|---------|-------------|
| Line No. | Length | Bearing |
| L1 | 254.98' | S65°39'13"E |
| L2 | 94.17' | S61°19'42"E |
| L3 | 357.46' | S47°52'08"E |
| L4 | 122.02' | S45°43'30"E |
| L5 | 380.30' | N86°05'23"E |

| Line Table | | |
|------------|---------|-------------|
| Line No. | Length | Bearing |
| L6 | 255.13' | N86°05'23"E |
| L7 | 188.45' | N58°15'04"E |

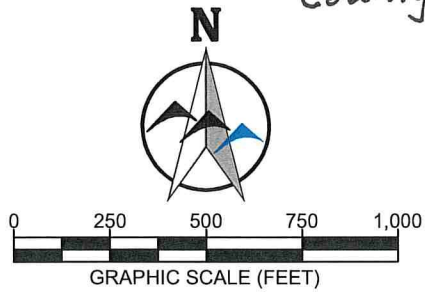

NOTES
BEARINGS ARE BASED ON THE WYOMING COORDINATE SYSTEM, NAD 1983, EAST CENTRAL ZONE.
DISTANCES ARE BASED ON U.S. SURVEY FOOT (GROUND).

RECORD OF SURVEY
SITUATED IN THE E1/2 OF SECTION 7,
T.57N., R.83W., 6TH P.M.,
SHERIDAN COUNTY, WYOMING

LEGEND

- SET 2-1/2" ALUMINUM CAP PLS 14277
- FOUND 1-1/2" ALUMINUM CAP PLS 10287
- FOUND 3-1/4" BRASS CAP LS 529
- FOUND 1-1/2" ALUMINUM CAP PLS 6594
- POINT OF BEGINNING
- TRACT 1

DESCRIPTION TRACT 1

A TRACT OF LAND BEING IN A PART OF THE NE1/4 OF SECTION 7, AND PART OF THE N1/2 OF SE1/4 OF SECTION 7 LYING NORTH OF THE BEATTY SPUR ROAD AND BEATTY GULCH ROAD, TOWNSHIP 57 NORTH, RANGE 83 WEST OF THE SIXTH PRINCIPAL MERIDIAN, SHERIDAN COUNTY, WYOMING AND IS MORE PARTICULARLY DESCRIBED AS FOLLOWS:

COMMENCING AT THE NORTH QUARTER CORNER OF SAID SECTION 7, MONUMENTED BY A BRASS CAP LS 529; THENCE ALONG THE CENTER QUARTER LINE OF SAID SECTION 7, S00°38'22"W A DISTANCE OF 1433.22 FEET TO THE POINT OF BEGINNING, MONUMENTED BY AN ALUMINUM CAP PLS 14277, ALSO BEING THE NORTHWEST CORNER OF TRACT 1; THENCE ALONG THE CENTER QUARTER LINE OF SAID SECTION 7, S00°38'22"W A DISTANCE OF 1484.70 FEET TO THE CENTERLINE OF BEATTY SPUR ROAD; THENCE ALONG THE SAID CENTERLINE OF BEATTY SPUR ROAD AND BEATTY GULCH ROAD FOR THE FOLLOWING 9 CALLS: S65°39'13"E A DISTANCE OF 254.98 FEET, THENCE THROUGH A CURVE TO THE RIGHT, HAVING A RADIUS OF 3650.00 FEET, A CENTRAL ANGLE OF 04°19'31", AN ARC LENGTH OF 275.54 FEET, A CHORD BEARING OF S63°29'28"E, AND A CHORD LENGTH OF 275.47 FEET, THENCE S61°19'42"E A DISTANCE OF 94.17 FEET, THENCE THROUGH A CURVE TO THE RIGHT, HAVING A RADIUS OF 2250.00 FEET, A CENTRAL ANGLE OF 13°27'34", AN ARC LENGTH OF 528.55 FEET, A CHORD BEARING OF S54°35'55"E, AND A CHORD LENGTH OF 527.34 FEET, THENCE S47°52'08"E A DISTANCE OF 357.46 FEET, THENCE THROUGH A CURVE TO THE RIGHT, HAVING A RADIUS OF 2890.00 FEET, A CENTRAL ANGLE OF 02°08'38", AN ARC LENGTH OF 108.14 FEET, A CHORD BEARING OF S46°47'49"E, AND A CHORD LENGTH OF 108.13 FEET, THENCE S45°43'30"E A DISTANCE OF 122.02 FEET, THENCE THROUGH A CURVE TO THE LEFT, HAVING A RADIUS OF 300.00 FEET, A CENTRAL ANGLE OF 48°11'09", AN ARC LENGTH OF 252.30 FEET, A CHORD BEARING OF S69°49'04"E, AND A CHORD LENGTH OF 244.93 FEET, THENCE N86°05'23"E A DISTANCE OF 380.30 FEET, MONUMENTED BY AN ALUMINUM CAP WITNESS CORNER PLS 14277 THAT BEARS N08°24'37"W A DISTANCE OF 26.00 FEET; THENCE LEAVING SAID CENTERLINE AND ALONG AN EXISTING FENCE N08°24'37"W A DISTANCE OF 1278.46 FEET, MONUMENTED BY AN ALUMINUM CAP PLS 14277, THENCE N28°13'33"W A DISTANCE OF 982.00 FEET, MONUMENTED BY AN ALUMINUM CAP PLS 14277; THENCE N03°26'11"E A DISTANCE OF 376.17 FEET, MONUMENTED BY AN ALUMINUM CAP PLS 14277; THENCE LEAVING SAID EXISTING FENCE N89°21'38"W A DISTANCE OF 1386.51 FEET TO THE POINT OF BEGINNING.

THE ABOVE DESCRIBED TRACT DESCRIPTION CONTAINS 80.00 ACRES, MORE OR LESS, AND IS SUBJECT TO ANY PREVIOUS EASEMENTS, AGREEMENTS, CONVEYANCES, AND SURVEYS.

CERTIFICATE OF RECORDER

STATE OF WYOMING) SS
COUNTY OF SHERIDAN)

THIS INSTRUMENT WAS FILED IN MY OFFICE AT 2:05 O'CLOCK ON Feb 3, 2022, AND FILED IN DRAWER A, PLAT NUMBER 653, INSTRUMENT NO. 2022-776201

FEES \$50.00 Eda Schunk Thompson
County Clerk



CERTIFICATE OF SURVEYOR

I, DIRK THOMPSON, A REGISTERED PROFESSIONAL LAND SURVEYOR, LICENSED UNDER THE LAWS OF THE STATE OF WYOMING, DO HEREBY STATE THAT THIS PLAT REPRESENTS THE RESULTS FROM A FIELD SURVEY MADE BY ME OR UNDER MY DIRECT SUPERVISION.

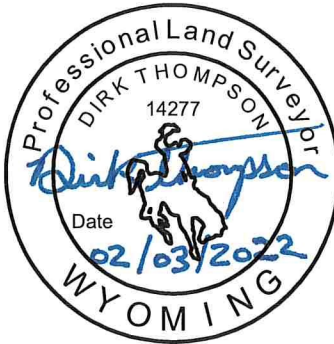

| | | | | |
|-------------|---|-----------------|--|----------------------|
| EXHIBIT 1 | SARAH FREDERICKSON 71 FRISBIE ROAD SHERIDAN, WY 82801 | | WWC ENGINEERING 1849 TERRA AVE. SHERIDAN, WY 82801 (307) 672-0761 www.wwcengineering.com | |
| | | | | |
| PAGE 1 OF 1 | DRAWN BY: CIG | CHECKED BY: JPC | APPROVED BY: DRT | SURVEY DATE: 1/30/22 |