

Summit Gas Resources, Inc.
1 E. Alger Street, Sheridan, WY 82801

NOTICE OF ASSIGNMENT OF EASEMENT

KNOW ALL MEN BY THESE PRESENTS:

The stated and undersigned Summit Gas Resources, Inc. (herein after called the assignor) hereby assigns; transfers and sells unto Powder River Energy Corporation, a Wyoming cooperative corporation utility (hereinafter called the assignee) whose corporate headquarters post office address is P.O. Box 930, Sundance, Wyoming and to its successors and assigns all the rights, title, and interest granted by their existing Power Line Right of Way Easement executed on May 16, 2012 by the easement grantor: Schauer Enterprises, LLC and located in the following:

T57N, R77W, 6th P.M., Sheridan County, Wyoming
SECTIONS 6, 7, 16, 17, and 18

and as shown on the attached map marked "Exhibit A and as recorded in book 533 on page 696.

POWDER RIVER ENERGY CORPORATION (BY SIGNATURE ONLY) ACKNOWLEDGES ACCEPTANCE OF THIS NOTICE OF ASSIGNMENT OF EASEMENT

IN WITNESS WHEREOF, the undersigned have set their hand this 18 day of May, 2012.

Assignor

ACKNOWLEDGEMENT

State of Wyoming

)ss

County of Sheridan

The foregoing instrument was acknowledged before me this 18 day of May, 2012

by Peter G. Schoonmaker

Witness my hand official seal

Alexis Anne Rapp

Notary Public

My commission expires: 11-21-2015

SEAL

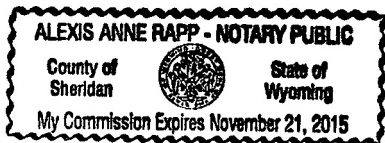

POWDER RIVER ENERGY CORPORATION SIGNATURE IS REQUIRED BEFORE THIS DOCUMENT IS FULLY ACCEPTED.

May Sacks
Accepted by: Powder River Energy Corporation
Project Supervisor

5-22-12
Date



2012-697539 7/5/2012 1:29 PM PAGE: 1 OF 2
BOOK: 534 PAGE: 728 FEES: \$11.00 MD EASEMENT
EDA SCHUNK THOMPSON, SHERIDAN COUNTY CLERK

EXHIBIT A

NO. 2012-697539 EASEMENT

EDA SCHUNK THOMPSON, SHERIDAN COUNTY CLERK
POWDER RIVER ENERGY CORPORATION PO BOX 937
GILLETTE WY 82717-0937

2

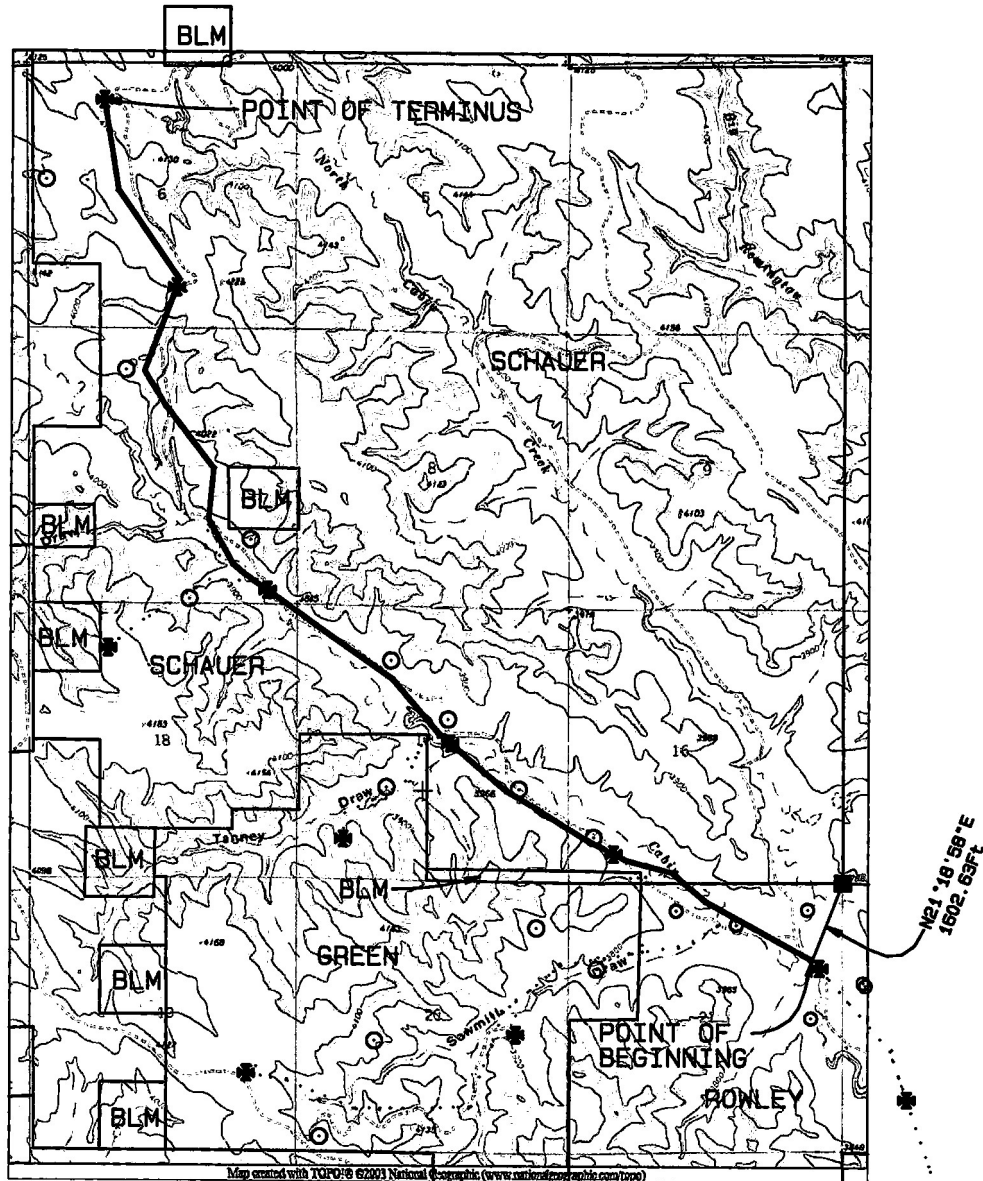

LEGEND

- ☒ TAP @ EXISTING THREE PHASE
- ✱ POWER DROP
- FOUND SECTION CORNER
- WELL



Basis of Bearings: ASTRONOMIC
(using Static/RTK GPS methods)

POWER LINE EASEMENT PLAN SUMMIT GAS PHASE 5

SECTIONS: 21, 22, 26, 27, 35, 36
ALL IN T57N, R77W, 6TH PM

NORTH PARK ENGINEERING &
CONSULTING, INC.

P.O. BOX 395
WALDEN, CO 80480
(970) 723-3753

DRAWING FILE: SUMMIT PH 5
DATE: 5/17/12

MEAS'D BY: R. MILLER
DRAWN BY: R. MILLER
CHECKED BY: R. MILLER

WD: 110449
PAGE 3 of 3

SCALE: 1" = 3000'



2012-697539 7/5/2012 1:29 PM PAGE: 20F
BOOK: 534 PAGE: 729 FEES: \$11.00 MD EASEMENT
EDA SCHUNK THOMPSON, SHERIDAN COUNTY CLERK