

270

RIGHT OF WAY EASEMENT

The undersigned, Grantor, in consideration of \$ 10.00 and other valuable consideration, hereby grants to PACIFIC POWER & LIGHT COMPANY, a corporation, its successors and assigns, Grantee, an easement for a right of way 125 feet in width for electric transmission and distribution lines of one or more wires and all necessary or desirable appurtenances, including telephone and telegraph wires, towers, poles, props, guys and other supports, along the general course now located by Grantee over the following described real property located in Sheridan County, State of Wyoming, to wit:

The East one-half ($E\frac{1}{2}$) of the Southeast quarter ($SE\frac{1}{4}$) of Section 7 and the West one-half ($W\frac{1}{2}$) of Section 8, Township 57 North, Range 83 West, 6th P.M.

as more particularly described on attached Exhibit(s) "A" & "A-1" by this reference made a part hereof.

The within grant shall include: the right to place all or any part of such lines underground; the right to install and maintain guys and anchors outside said right of way; the right to clear said right of way and keep the same clear of brush, trees, timber and structures; the present and future right to clear and cut away all trees outside of said right of way which might endanger said transmission lines; the right to construct, reconstruct, operate, maintain, replace, enlarge, repair and remove any of said facilities; the right in the future to construct, reconstruct, operate, maintain and remove additional lines, wires and all necessary or desirable poles, structures and appurtenances thereto; and the right of ingress and egress over adjacent lands of Grantor for all said purposes.

Grantee shall pay to Grantor reasonable compensation for any damage caused by Grantee to any property or crops on the above-described real property arising out of the use thereof by Grantee.

At no time shall any flammable material or any building of any kind be placed or erected within the boundaries of said right of way, nor shall any equipment or material of any kind that exceeds 20 feet in height be placed or used thereon by Grantor or by Grantor's heirs, successors or assigns.

Subject to the foregoing limitations, said right of way may be used by Grantor for roads, agricultural crops and other purposes not inconsistent with said easement.

All such rights hereunder shall cease if and when such lines shall have been abandoned.

Executed this 13th day of November, 19 70, hereby releasing and waiving all rights under and by virtue of the homestead exemption laws of the State of Wyoming.

GRANTOR

Elmer J. Mydland
Elmer J. Mydland
Suzanne L. Mydland
Suzanne L. Mydland GRANTOR

STATE OF WYOMING)
County of Sheridan) ss.

The foregoing instrument was acknowledged before me this 13 day of Nov, 19 70.

Witness my hand and official seal:



Elmer J. Mydland
Notary Public for Wyoming
My Commission expires: Nov 6, 1970

THE UNITED STATES OF AMERICA
DEPARTMENT OF THE INTERIOR
BUREAU OF LAND MANAGEMENT

WATER RESOURCES DIVISION

REPORT OF THE
SPECIAL INVESTIGATION OF THE
WATER RESOURCES OF THE
SOUTHERN MOUNTAIN REGION
BY
J. W. GIBSON
1934

WATER RESOURCES DIVISION
BUREAU OF LAND MANAGEMENT
DEPARTMENT OF THE INTERIOR
WASHINGTON, D. C.

WATER RESOURCES DIVISION
BUREAU OF LAND MANAGEMENT
DEPARTMENT OF THE INTERIOR
WASHINGTON, D. C.

WATER RESOURCES DIVISION
BUREAU OF LAND MANAGEMENT
DEPARTMENT OF THE INTERIOR
WASHINGTON, D. C.

WATER RESOURCES DIVISION
BUREAU OF LAND MANAGEMENT
DEPARTMENT OF THE INTERIOR
WASHINGTON, D. C.

WATER RESOURCES DIVISION
BUREAU OF LAND MANAGEMENT
DEPARTMENT OF THE INTERIOR
WASHINGTON, D. C.

WATER RESOURCES DIVISION
BUREAU OF LAND MANAGEMENT
DEPARTMENT OF THE INTERIOR
WASHINGTON, D. C.

WATER RESOURCES DIVISION
BUREAU OF LAND MANAGEMENT
DEPARTMENT OF THE INTERIOR
WASHINGTON, D. C.

WATER RESOURCES DIVISION
BUREAU OF LAND MANAGEMENT
DEPARTMENT OF THE INTERIOR
WASHINGTON, D. C.

WATER RESOURCES DIVISION
BUREAU OF LAND MANAGEMENT
DEPARTMENT OF THE INTERIOR
WASHINGTON, D. C.

WATER RESOURCES DIVISION
BUREAU OF LAND MANAGEMENT
DEPARTMENT OF THE INTERIOR
WASHINGTON, D. C.

WATER RESOURCES DIVISION
BUREAU OF LAND MANAGEMENT
DEPARTMENT OF THE INTERIOR
WASHINGTON, D. C.

WATER RESOURCES DIVISION
BUREAU OF LAND MANAGEMENT
DEPARTMENT OF THE INTERIOR
WASHINGTON, D. C.

WATER RESOURCES DIVISION
BUREAU OF LAND MANAGEMENT
DEPARTMENT OF THE INTERIOR
WASHINGTON, D. C.

WATER RESOURCES DIVISION
BUREAU OF LAND MANAGEMENT
DEPARTMENT OF THE INTERIOR
WASHINGTON, D. C.

WATER RESOURCES DIVISION
BUREAU OF LAND MANAGEMENT
DEPARTMENT OF THE INTERIOR
WASHINGTON, D. C.

WATER RESOURCES DIVISION
BUREAU OF LAND MANAGEMENT
DEPARTMENT OF THE INTERIOR
WASHINGTON, D. C.

WATER RESOURCES DIVISION
BUREAU OF LAND MANAGEMENT
DEPARTMENT OF THE INTERIOR
WASHINGTON, D. C.

38-263

T. 57N., R. 83W. GERM.

ELEVATION 36.5 BK
EQUATION 36.49 AL

ELEVATION 28.0 BK
EQUATION 28.0 BK

Match'n mark

270-11

7
15

R/W
N 35° 20' 30" E

FOR LINE ELEV
EQUATION SET

PACIFIC POWER & LIGHT CO.

Elmer L. & Suzanne L. Medland
SECTION 7 T. 57N. R. 83W. M.P.M.
SHERIDAN COUNTY,
DATE 11-13-72 DANTORS *E. L. M.*
SCALE 1" = 400 EXHIBIT "A"
ACRES

271

PACIFIC POWER & LIGHT CO.
 River J. & Suzanne L. Mydland
 SECTION 8 T. 57N. R. 83W. M.P.M.
 SHERIDAN COUNTY,
 DATE 1-13-77 GRANTORS *E. J. and*
 SCALE = 400' EXHIBIT "A" - 1
 C.L. LENGTH / ACRES

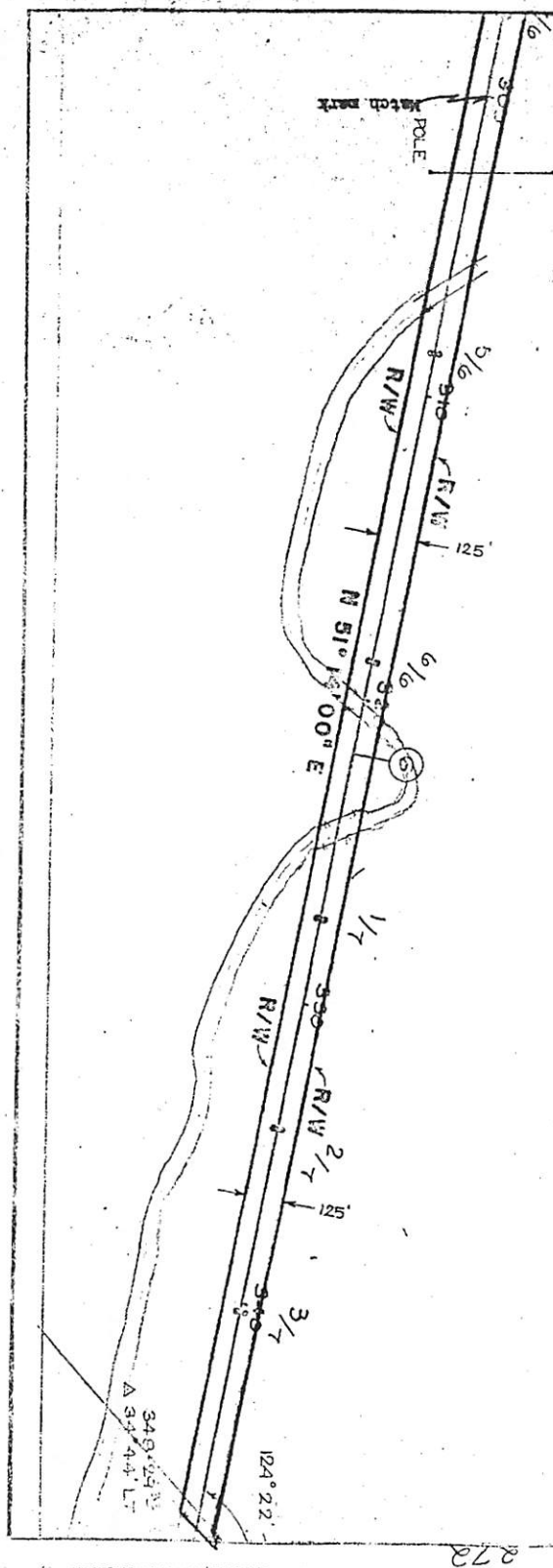

River J. Mydland

308-5

318-7

327-2

334-1

340-2

272

