



Notice of Grazing and Haying Lease

Fidelity Exploration & Production Company, ("Lessor") whose address is 1700 Lincoln, Suite 2800, Denver, CO 80203 and Bert W. Dow as Trustee of the Bert W. Dow Revocable Trust dated March 6, 2003 ("Lessee") whose address is 63 Dow Road, Sheridan, WY 82801 entered into a Grazing and Haying Lease relating to the property described on attached Exhibits A and B and depicted on Exhibit A-1.

The lease is for a term effective November 1, 2007 through November 1, 2012 as to the grazing rights defined in the lease, and the Lessee has the right to harvest alfalfa hay on the lands described in Exhibit B in 2008 with the option to harvest alfalfa hay on the lands described on Exhibit B on a year by year basis for an additional four years subject to certain limitations contained in the Grazing and Haying Lease. The document is executed pursuant to Section 21 of the Grazing and Haying Lease, and nothing in this notice shall alter or amend any of the terms of the Grazing and Haying Lease.

Dated this 26th day of February, 2009.

Bert W. Dow, Trustee of the Bert W. Dow
Revocable Trust dated March 6, 2003

Fidelity Exploration & Production Company

By:

Marvin ~~E~~. Rygh, Vice President- *ulR 2/23/09*
Southern Rockies



STATE OF WYOMING)
) ss.
COUNTY OF SHERIDAN)

The foregoing instrument was acknowledged before me this 16 day of July, 2009, by Bert W. Dow, Trustee of the Bert W. Dow Revocable Trust dated March 6, 2003.

Witness my hand and official seal.

Tom C. Dow
Notary Public

My Commission Expires: Nov. 26, 2009

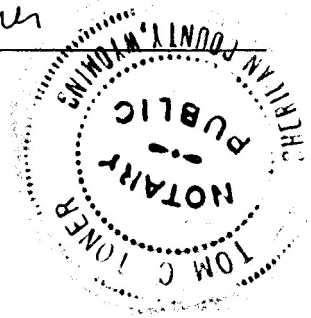

STATE OF Colorado)
city and) ss.
COUNTY OF Denver -)

The foregoing instrument was acknowledged before me this 26 day of February, 2009, by Marvin E. Rygh, Vice President-Southern Rockies of Fidelity Exploration & Production Company.

Witness my hand and official seal.

Lana Thompson
Notary Public

My Commission Expires: 2/24/2010

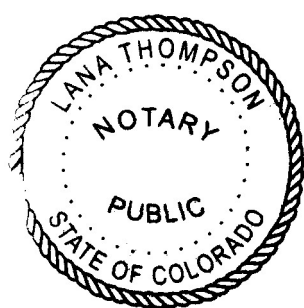

Commission Expires 1/24/2010



EXHIBIT "A"

Attached to and made a part of that certain Grazing Lease, dated the 12th day of October, 2007, by and between, **Seven Brothers Ranches, Inc.**, as Lessor, and **Bert Dow**, as Lessee.

SEVEN BROTHERS NORTH RANCH

Sheridan County, Wyoming

Township 58 North, Range 82 West, 6th P M

Section 19: Lot 4, that portion of Lot 3 lying North and West of Lower Prairie Dog Road, and that portion of Lot 5 lying North and West of Lower Prairie Dog Road

Township 58 North, Range 83 West, 6th P M

Section 24: Lot 1, SE/4NE/4, and that portion of the S/2 lying East of the railroad tracts and North and West of the Lower Prairie Dog Road.

Big Horn County, Montana

Township 9 South Range 40 East, MPM

Section 34: Lots 3, 4, N/2SE/4 (a/d/a SE/4)

Section 35: Lots 1, 2, N/2SW/4, NW/4, and that part of the E/2 lying west of Lower Prairie Dog Road (a/d/a All lying west of Lower Prairie Dog Road)

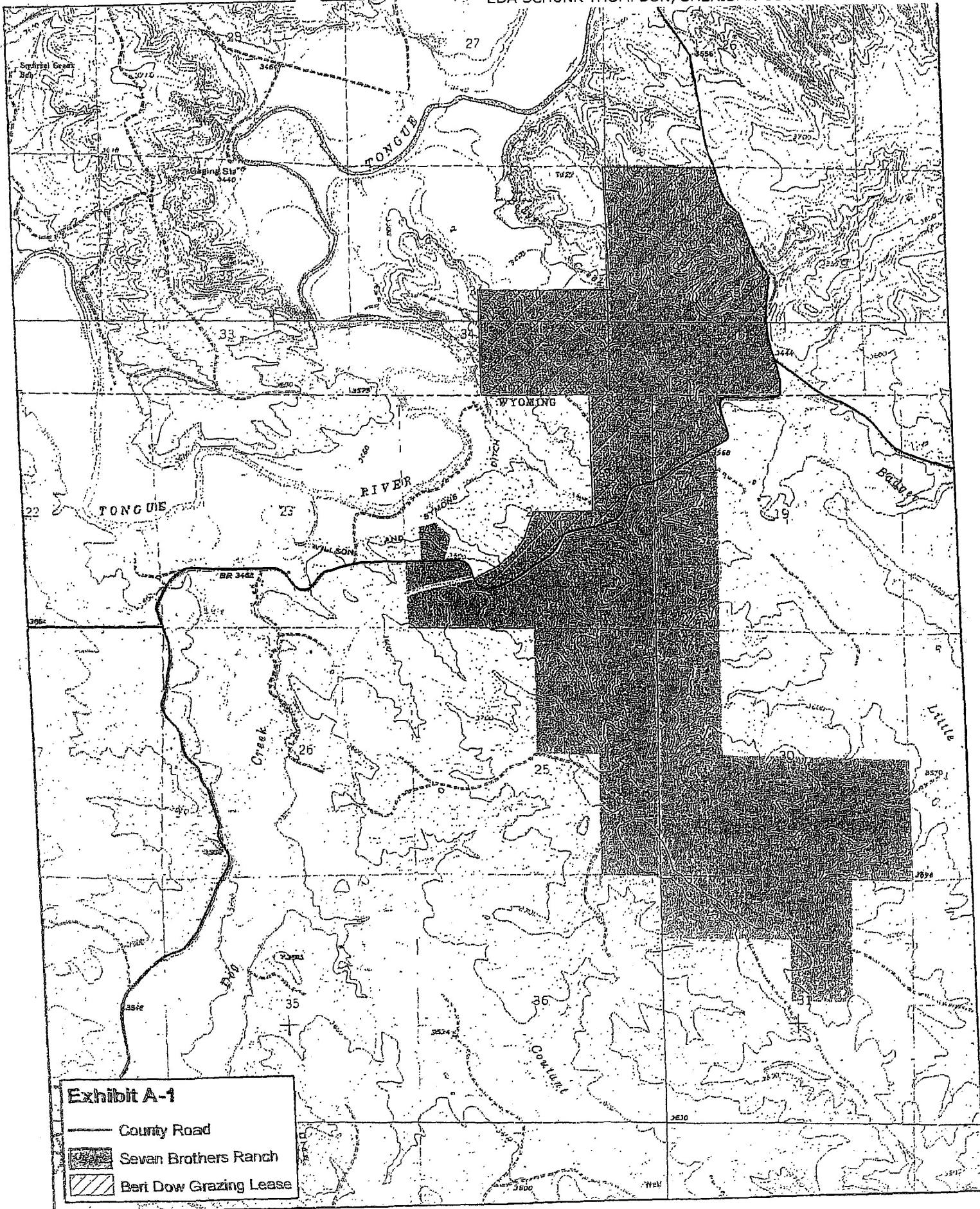



EXHIBIT "B"

Township 58 North, Range 82 West, 6th P.M.

Section 19: That portion of the W1/2W1/2 lying south of Lower Prairie Dog Road

Section 30: W1/2NW1/4, S1/2

Section 31: W1/2NE1/4, N1/2NW1/4

Township 58 North, Range 83 West, 6th P.M.

Section 24: That portion of the S1/2 lying south of Lower Prairie Dog Road

Section 25: NE1/4, E1/2SE1/4

NO. 2011-690279 NOTICE

EDA SCHUNK THOMPSON, SHERIDAN COUNTY CLERK
YONKEE & TONER P O BOX 6288
SHERIDAN WY 82801