

SITUATED IN THE SE1/4SW1/4 SEC. 21, NW1/4, W1/2SW1/4 SEC.28,
SE1/4NE1/4 SEC.29, TOWNSHIP 58 NORTH, RANGE 82 WEST, 6TH
PRINCIPAL MERIDIAN, SHERIDAN COUNTY, WYOMING

FOR THE PURPOSES OF CREATING A BOUNDARY LINE ADJUSTMENT IN ACCORDANCE WITH WYOMING
LAW. AND DOES NOT HAVE THE EFFECT OF CREATING ANY NEW, SEPARATELY OWNED PARCEL.

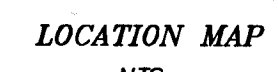

TRACTS 1-3 (SUSAN DOWN TRUST TO KATHLEEN A. LARSEN)

A tract of land situated in the SE $\frac{1}{4}$ SW $\frac{1}{4}$ of Section 21, NW $\frac{1}{4}$ NW $\frac{1}{4}$, E $\frac{1}{2}$ NW $\frac{1}{4}$ of Section 28, Township 58 North, Range 82 West, 6th Principal Meridian, Sheridan County, Wyoming; said tract being more particularly described as follows:

Commencing at the southwest corner of said NW¼ (monumented with a 3" brass cap per PLS 5369); thence N53°36'42"E, 2149.32 feet to a 1½" aluminum cap per PLS 5369 placed on the ground found 60' rear being the **POINT OF BEGINNING, said point being the easterly point of a tract of land described in Book 577 of Deeds, Page 199;**

thence N53°50'04"W, 567.43 feet along the northeasterly line of said tract to a 1½" aluminum cap per PLS 2615 being the northeasterly corner of said tract;

thence N13°51'00"E, 531.26 feet along the easterly line of a tract of land described in Book 568 of Deeds, Page 267 to a 1½" aluminum cap per PLS 2615;

thence S02°14'40"E, 429.50 feet along the easterly line of a tract of land described in Book 568 of Deeds, Page 264 to a 1½" aluminum cap per PLS 2615;

thence N36°00'25"E, 351.63 feet along said easterly line to the easterly corner of said tract lying on the centerline of Badger Road (AKA County Road No. 122) and being witnessed by 1½" aluminum cap per PLS 2615 bears S30°02'25"W a distance of 185.76 feet;

thence S33°32'17"E, 176.93 feet along said easterly line to the intersection of the centerline and the extension of a fence bearing southwesterly a distance of 121.76 feet per PLS 5369 lying on said extended fence line and bearing S221°36'W a distance of 204.71 feet;

thence S221°36'W, 626.37 feet along said fence line to a 2" aluminum cap per PLS 5369;

thence S183°40'W, 220.99 feet along said fence line to a 2" aluminum cap per PLS 5369;

thence S44°31'17"E, 183.13 feet along said fence line to a 2" aluminum cap per PLS 5369;

thence S01°28'39"E, 51.12 feet along said fence line to a 2" aluminum cap per PLS 5369;

thence S42°51'31"W, 27.21 feet along said fence line to the **POINT OF BEGINNING**.

Containing 8.95 acres more or less.

TRACT No.2

A tract of land situated in the S½NW¼, NW¼SW¼ of Section 28, Township 58 North, Range 82 West, 6th Principal Meridian, Sheridan County, Wyoming; said tract more particularly described as follows:

Commencing at the southwest corner of said NWK (monumented with a 3/4" brass cap per PLS 5369); thence N63°56'42" E, 214.03 feet along said aluminum cap per PLS 5369 placed on a found #5 rebar being the POINT OF BEGINNING said point being the easterly point of a tract described in Book 57 of Deeds, Page 199 and lying on said fence line, thence S50°26'37" E, 1590.96 feet along said aluminum cap per PLS 5369; thence S182°31'10" W, 219.30 feet along said fence line to a 2" aluminum cap per PLS 5369; thence S34°50'59" W, 537.04 feet along said fence line to a 2" aluminum cap per PLS 5369; thence S50°26'37" E, 1590.96 feet along said fence line to a 2" aluminum cap per PLS 5369, lying at the intersection of said fence line with the boundary line of said NWK, thence S182°31'10" W, 219.30 feet along said fence line to a 2" aluminum cap per PLS 5369; thence S50°26'37" E, 1424.71 feet along said southerly line and leaving said fence line to a plastic cap per PLS 3892; thence S182°31'10" W, 219.31 feet along said southerly line to a plastic cap per PLS 3892; thence N164°10'10" E, 385.71 feet along said southerly line to the POINT OF BEGINNING.

Containing 0.52 acres more or less.

TRACT No.3

A tract of land situated in the SW $\frac{1}{4}$ SW $\frac{1}{4}$ of Section 28, Township 58 North, Range 82 West, 6th Principal Meridian, Sheridan County, Wyoming; said tract more particularly described as follows:

Commencing at the southwest corner of said NW¼ (monumented with a 3¼" brass cap per PLS 5369); thence S01°27'46"E, 1703.92 feet to a 2" aluminum cap per PLS 5369 being the **POINT OF BEGINNING**, said point lying on the east line of a tract of land described in Book 577 of Deeds, Page 199 and lying on a fence line;

thence S17°02'43"E, 902.22 feet along said fence line and leaving said east line to a 2" aluminum cap per PLS 5369 returning to said east line;
thence N18°27'40"W, 499.95 feet leaving said fence line and along said east line to a 2" aluminum cap per PLS 5369;
thence N42°15'46"W, 160.19 feet along said east line to the **POINT OF BEGINNING**.

Containing 0.46 acres of land, more or less.

TRACT 4 (KATHLEEN A. LARSEN TO SUSAN DOW TRUST)

A tract of land situated in the SW $\frac{1}{4}$ SW $\frac{1}{4}$ of Section 28, Township 58 North, Range 82 West, 6th Principal Meridian, Sheridan County, Wyoming; said tract more particularly described as follows:

BEGINNING at the southwest corner of said Section 28 (monumented with a GLO brass cap; thence N00°40'55"E, 126.60 feet along the west line of said Section 28 to a 2" aluminum cap per PLS 5369 lying on the east line of said Section 28 to the ***POINT OF BEGINNING***; thence S45°08'08"E, 339.89 feet along said fence line to a 2" aluminum cap per PLS 5369 lying on the east line of a tract of land described in Book 577 of Deeds, Page 199; thence S182°27'40"E, 95.70 feet along said east line and leaving said fence line to a 2" aluminum cap lying on the south line of said tract; thence S89°52'36"W, 369.90 feet along said south line to the ***POINT OF BEGINNING***.

Containing 0.88 acres more or less.

TIE	BEARING	LENGTH
No.1	N53°36'42"E	2149.32
No.2	S01°27'46"E	1703.92

LEGEND:

- ◆ GLO BRASS CAP
 ■ 3-1/4" BRASS CAP PER PLS 5369
 ○ FOUND 1-1/2" ALUMINUM CAP PER PLS 2615
 ■ FOUND PLASTIC CAP PER PLS 3892
 ◎ SET 2" ALUMINUM CAP PER PLS 5369
 ○ NOT FOUND,/NOT SET
 (xxx) DENOTES RECORD
 W.C. WITNESS CORNER
 - - - SECTION LINE
 - - - INTERIOR SECTION LINE
 _____ PROPERTY LINE
 _____ FENCE LINE
 ○ - - - PROPERTY LINE TO BE ADJUSTED
 ■ ■ ■ ■ ■ ADJUSTED PROPERTY LINE ALONG FENCE LINE
 ■ ■ ■ ■ ■ ADJUSTED COMMON PROPERTY LINE

NOTICE:
This plat is an image of a
Sheridan County Clerk
authoritative depiction of cur-
rent way. Delineations, measurement
since the original plat was recorded.

CERTIFICATE OF RECORDER

STATE OF WYOMING : ss
COUNTY OF SHERIDAN

I HEREBY CERTIFY THAT THIS PLAT WAS FILED FOR RECORD IN MY OFFICE OF AT 3:45 O'CLOCK P.M.,
THIS 18, DAY OF April, 2024, AND RECORDED IN PLAT BOOK A, ON PAGE 736
Rec # 2024-791466

Elda Schunk Thompson
COUNTY CLERK

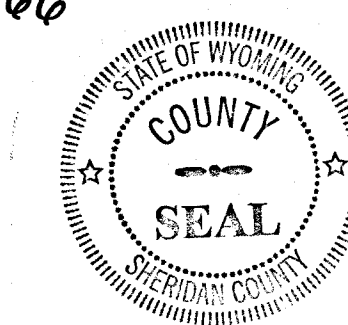

I, THONE STEWART, A DULY REGISTERED LAND SURVEYOR
IN THE STATE OF WYOMING, DO HEREBY STATE THAT THIS
PLAT REPRESENTS THE RESULTS OF A SURVEY MADE BY
ME OR UNDER MY DIRECT SUPERVISION.

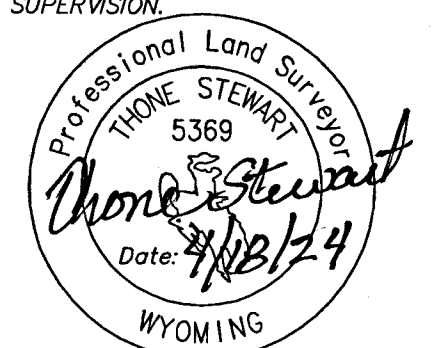

SITUATED IN THE SE1/4SW1/4 SEC. 21, NW1/4, W1/2SW1/4 SEC.28,
SE1/4NE1/4 SEC.29, TOWNSHIP 58 NORTH, RANGE 82 WEST, 6TH
PRINCIPAL MERIDIAN, SHERIDAN COUNTY, WYOMING

RESTFELDT
SURVEYING
2340 WETLANDS DR., SUITE 100
PO BOX 3082
SHERIDAN, WY 82801
307-672-7415

CLIENT: KATHY LARSEN
216 BADGER CREEK ROAD
SHERIDAN, WY 82801

N: 2024-002
 N: 2024-002D
 AB: PLAT
 PF: T2024-002
 April, 2024