

SW1/4NE1/4, SECTION 18, TOWNSHIP 53 NORTH, RANGE 83 WEST,
6TH PRINCIPAL MERIDIAN, SHERIDAN COUNTY, WYOMING

Lat. N44°34'20.202"
Long. W106°53'31.776"
NAD 83(93)

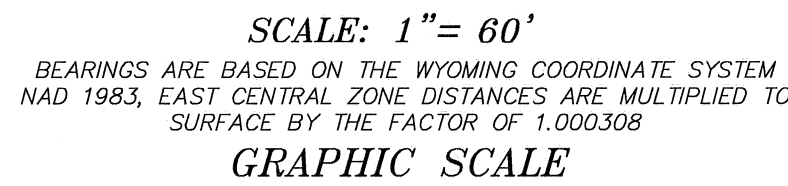

A site map showing the location of the 'SITE' (shaded area) relative to Fish Hatchery Road, Aka State Highway No. 194, South Piney Creek, and a Summer Line. The map also shows a wagon box road on the right side.

RE: GRANTOR HJORTH (BOOK 563 OF DEEDS, PAGE 88,
GRANTEE HJORTH (BOOK 490 OF DEEDS, PAGE 167)

A tract of land situated in the SW¼NE¼ of Section 18, Township 53 North, Range 83 West, 6th Principal Meridian, and being a portion of a parcel described in Book 563 of Deeds, Page 88, Sheridan County, Wyoming; said tract being more particularly described as follows:

Commencing at the northeast corner of said Section 18 (monumented with a 3" Brass Cap per PLS 102); thence S43°40'11"W, 2534.34 feet to the **POINT OF BEGINNING**, said point being the south line of said parcel and witnessed by a No.5 rebar bears N79°30'00"W a distance of 100.00 feet;

thence N79°30'00"W, 473.53 feet along the south line of said parcel to a point on the thread of South Piney Creek as described in said Book 563 of Deeds, Page 88, witnessed by a 2" aluminum cap per PLS 2615 bears S79°30'00"E a distance of 45.04 feet;

thence N68°26'59"E, 172.69 feet along said thread to a point witnessed by a 2" aluminum cap per PLS 5369 bears S68°13'08"E, a distance of 2.00;

thence S68°13'08"E, 360.72 feet to a point per PLS 5369, lying on the easterly line of said parcel;

thence S52°13'50"W, 35.01 feet along said easterly line to the **POINT OF BEGINNING**.

Said TRACT 1 containing 0.65 acres more or less.

A tract of land situated in the SW¹/₄NE¹/₄ of Section 18, Township 53 North, Range 83 West, 6th Principal Meridian, and being a portion of a parcel described in Book 563 of Deeds, Page 88, Sheridan County, Wyoming; said tract being more particularly described as follows:

BEGINNING at the northeast corner of said parcel (monumented with a 2" aluminum cap per PEKLS 3864) and being S45°12'48"W, 1887.74 feet along a 3" Brass Cap per PLS 102 being the northeast corner of said parcel, thence S00°06'23"W, 201.00 feet along the east line of said parcel and the west line of a tract described in document #22022-77833.3 to a 2" aluminum cap per PLS 5369;
thence S04°09'42"W, 100.00 feet along the southeasterly line of said parcel to a 2" aluminum cap per PLS 5369;
thence S52°13'49"W, 474.79 feet along said southeasterly line to a 2" aluminum cap per PLS 5369;
thence N68°13'08"W, 350.72 feet to the thread of South Piney, Cr. (hereinafter "thread of said creek"), thence S86°13'08"E, 201.00 feet along said thread to a 2" aluminum cap per PLS 5369 being S68°13'08"E a distance of 20 feet; thence N54°26'47"E, 130.28 feet along said thread to a point; thence N37°34'18"E, 104.52 feet along said thread to a point; thence N28°14'12"E, 102.18 feet along said thread to a point; thence N53°51'17"E, 73.99 feet along said thread to a point; thence N73°35'41"E, 120.34 feet along said thread to a point; thence N53°37'16"E, 55.46 feet along said thread to a point, being the northeasterly corner of said parcel, witnessed by a 2" aluminum cap per PLS 5369 being N89°34'39"E a distance of 40 feet;
thence N89°34'39"E, 294.81 feet along the north line of said parcel and the north line of said creek as described in Book 382 of Deeds, Page 374 to the **POINT OF BEGINNING.**

Said **TRACT 2** containing 4.81 acres more or less.

STATE OF WYOMING : ss
COUNTY OF SHERIDAN

THIS PLAT WAS FILED FOR RECORD IN THE OFFICE OF THE CLERK AND RECORDER AT 9:17 O'CLOCK A.M.,
THIS 4 DAY OF October, 2024, AND IS DULY RECORDED AS SURVEY A, NO. 756
FEE \$ 50.00

Kimberly Hein chief deputy
COUNTY CLERK

STAMP RECEIVING NUMBER 2024-794849

SW1/4NE1/4, SECTION 18, TOWNSHIP 53 NORTH, RANGE 83 WEST,
6TH PRINCIPAL MERIDIAN, SHERIDAN COUNTY, WYOMING

RESTFELDT
SURVEYING
2340 WETLANDS DR., SUITE 100
SHERIDAN, WY 82801
307-672-7415

CLIENTS: CURTIS HJORTH
P.O. BOX 640
STORY, WY 82842
(37 SPURRIER LANE)

JN: 2006-055 SJ: 2
DN: 2006-055-BLA
TAB: BLA
PF: T2006-055-2024
REVIEWED BY: JSP
SEPTEMBER 17, 2024

LINE TABLE		
LINE	BEARING	LENGTH
L1	S78°47'00"W	21.40'
L2	S52°13'50"W	35.01'
L3	S53°11'36"W	8.96'
L4	N30°36'34"W	20.00'
L5	S44°24'39"W	14.92'
L6	N47°54'21"W	28.91'
L7	S50°22'46"W	41.85'
L8	N00°06'29"E	27.75'

I, THONE STEWART, A DULY REGISTERED LAND SURVEYOR
IN THE STATE OF WYOMING, DO HEREBY STATE THAT THIS
RECORD OF SURVEY IS A VALID REPRESENTATION OF A
SURVEY MADE BY ME OR UNDER MY DIRECT SUPERVISION.

LEGEND:

- SET 2" ALUMINUM CAP PER PLS 5369
 5/8" REBAR - SET 2" ALUMINUM CAP PER PLS 5369
 ◇ FOUND 2" ALUMINUM CAP PER PLS 2615
 ▣ FOUND 2" ALUMINUM CAP PER P&LS 3864
 ◆ FOUND 2" ALUMINUM CAP PER P&LS 3159
 ▣ FOUND 3" BRASS CAP PLS 102
 ◇ FOUND 3-1/4" ALUMINUM CAP PER PLS 2615
 ◇ FOUND 5/8" REBAR
 ◎ FOUND IRON PIPE
 □ FOUND 2" ALUMINUM CAP PER PLS 2812
 ○ CALCULATED: NOTHING FOUND, NOTHING SET
 (R) RECORD
 (M) MEASURED
 BOUNDARY LINE
 --- BOUNDARY ADJUSTMENT LINE
 --- TRACT LINE, LOT LINE
 --- SECTION LINE
 --- INTERIOR SECTION LINE
 --- EDGE OF 15' RIGHT-OF-WAY AGREEMENT
 --- APPROXIMATE EDGE SOUTH PINEY CREEK
 WC WITNESS CORNER

RECORD OWNERS:
BENJAMIN ANDREW & DIANE ROMAN
(2022-783179)

RECORD OWNER:
ROMANJENKO JULIEN LLC
(2021-773173)

RECORD OWNER:
BEVERLY A. BURTON
(BOOK 452, PAGE 37)

RECORD OWNERS:
HOLY NAME CHURCH
(BOOK 382, PAGE 374)

RECORD OWNER:
CURT HJORTH
(BOOK 563, PAGE 88)

TRACT 2
TOTAL: ±4.81 ACRES
AFTER BOUNDARY LINE ADJUSTMENT

RECORD OWNERS:
LANY N & MARGARET A. WISCH
(BOOK 363, PAGE 312)

RECORD OWNER:
CURTIS HJORTH
(BOOK 490, PAGE 167)

FINAL TRACT
TOTAL: ±3.20 ACRES
AFTER BOUNDARY LINE ADJUSTMENT

LOT 1

LOT 2

RALPHENUSH SURVIVISION