

OSPREY HILL TWO FINAL PLAT

A Part of The SW1/4 Section 28 and SE 1/4 Section 29, T56N R84W 6th P.M.
CITY OF SHERIDAN, SHERIDAN COUNTY, WYOMING

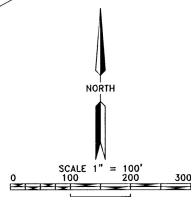
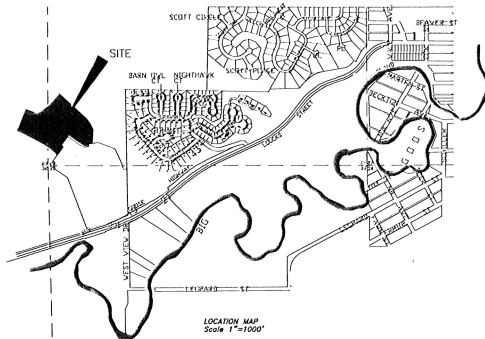

CERTIFICATE OF OWNER

That this subdivision, as it is described and as it appears on this plat is made with the free consent and in accordance with the desire of the undersigned owner; and that this is a correct plat of the area as it is divided into lots, blocks, streets and easements, and

Utility easements, as designated on this plat, are hereby dedicated to the City of Sheridan and its successors for the purpose of installing, repairing, maintaining, replacing and maintaining water, sewer, gas, electric lines, telephone lines, cable TV lines and other forms and public utilities now or hereafter generally utilized by the public.

Utility easements, as designated on this plat, are hereby dedicated to the City of Sheridan and its successors for the purpose of installing, repairing, maintaining, replacing and maintaining water, sewer, gas, electric lines, telephone lines, cable TV lines and other forms and public utilities now or hereafter generally utilized by the public.

CERTIFICATE OF OWNER

All rights under and by virtue of the homestead exemption laws of the State of Wyoming are hereby waived and released.

Executed this 1st day of April, 2006, by
Gene Kilpatrick
Owner
Gene Kilpatrick, President
Three Left Handers, LLC

STATE OF WYOMING } ss.
SHERIDAN COUNTY }

The foregoing instrument was acknowledged before me this 12th day of August, 2006, by *Gene Kilpatrick*, Witness my hand and official seal.

Notary Public
Wayne H. Dygert
Wayne H. Dygert

STATE OF WYOMING } ss.
SHERIDAN COUNTY }

The foregoing instrument was acknowledged before me this 11th day of August, 2006, by *Wayne H. Dygert*, Witness my hand and official seal.

Notary Public
Wayne H. Dygert
Wayne H. Dygert

CERTIFICATE OF SURVEY

I, William E. Dygert, a registered land surveyor in the state of Wyoming do hereby certify that this plat was prepared from notes taken during a survey performed by me or under my supervision during February 2006.

Notary Public
Wayne H. Dygert
Wayne H. Dygert

STATE OF WYOMING } ss.
SHERIDAN COUNTY }

The foregoing instrument was acknowledged before me this 11th day of August, 2006, by *Wayne H. Dygert*, Witness my hand and official seal.

Notary Public
Wayne H. Dygert
Wayne H. Dygert

LEGEND

These standard symbols will be found in the drawing.

Boundary
Lot Line
Right of Way
Building Setback Line
Easement Line
Existing Monument
Rebar with Aluminum Cap RLS 3300
Curve PC or PT

First Interstate Bank Mortgage

STATE OF WYOMING } ss.
SHERIDAN COUNTY }

The foregoing instrument was acknowledged before me this 12th day of August, 2006, by *Barbara Lee Farn*, Witness my hand and official seal.

Notary Public
Barbara Lee Farn
Barbara Lee Farn

CERTIFICATE OF PUBLIC PLANNING COMMISSION

Reviewed by the City of Sheridan Planning Commission this 22nd day of August, 2006.

Attest: Vice-Chairman
Wayne H. Dygert
Wayne H. Dygert

CERTIFICATE OF CITY COUNCIL

Approved by the City Council of the City of Sheridan, Wyoming, this 22nd day of August, 2006.

Attest: City Clerk
Wayne H. Dygert
Wayne H. Dygert

CERTIFICATE OF PUBLIC WORKS

This plat has been prepared in accordance with the requirements and procedures outlined in the Sheridan Regulations of the City of Sheridan, Wyoming, this 22nd day of August, 2006.

Attest: Director of Public Works
Wayne H. Dygert
Wayne H. Dygert

CERTIFICATE OF RECORDER

I hereby certify that the above plat was filed for record in my office at 3:00 o'clock on the 7th day of August, 2006 and filed as instrument No. 23,522.

Notary Public
Wayne H. Dygert
Wayne H. Dygert

LINE	BEARING	DISTANCE
L1	N 67°10'29" W	30.69
L2	N 27°49'51" E	138.05
L3	N 47°09'00" E	187.89
L4	S 47°14'58" E	92.00

LINE	BEARING	DISTANCE
L1	N 67°10'29" W	30.69
L2	N 27°49'51" E	138.05
L3	N 47°09'00" E	187.89
L4	S 47°14'58" E	92.00

LINE	BEARING	DISTANCE
L1	N 67°10'29" W	30.69
L2	N 27°49'51" E	138.05
L3	N 47°09'00" E	187.89
L4	S 47°14'58" E	92.00

LINE	BEARING	DISTANCE
L1	N 67°10'29" W	30.69
L2	N 27°49'51" E	138.05
L3	N 47°09'00" E	187.89
L4	S 47°14'58" E	92.00

LINE	BEARING	DISTANCE
L1	N 67°10'29" W	30.69
L2	N 27°49'51" E	138.05
L3	N 47°09'00" E	187.89
L4	S 47°14'58" E	92.00

LINE	BEARING	DISTANCE
L1	N 67°10'29" W	30.69
L2	N 27°49'51" E	138.05
L3	N 47°09'00" E	187.89
L4	S 47°14'58" E	92.00

LINE	BEARING	DISTANCE
L1	N 67°10'29" W	30.69
L2	N 27°49'51" E	138.05
L3	N 47°09'00" E	187.89
L4	S 47°14'58" E	92.00

LINE	BEARING	DISTANCE
L1	N 67°10'29" W	30.69
L2	N 27°49'51" E	138.05
L3	N 47°09'00" E	187.89
L4	S 47°14'58" E	92.00

LINE	BEARING	DISTANCE
L1	N 67°10'29" W	30.69
L2	N 27°49'51" E	138.05
L3	N 47°09'00" E	187.89
L4	S 47°14'58" E	92.00

LINE	BEARING	DISTANCE
L1	N 67°10'29" W	30.69
L2	N 27°49'51" E	138.05
L3	N 47°09'00" E	187.89
L4	S 47°14'58" E	92.00

LINE	BEARING	DISTANCE
L1	N 67°10'29" W	30.69
L2	N 27°49'51" E	138.05
L3	N 47°09'00" E	187.89
L4	S 47°14'58" E	92.00

LINE	BEARING	DISTANCE
L1	N 67°10'29" W	30.69
L2	N 27°49'51" E	138.05
L3	N 47°09'00" E	187.89
L4	S 47°14'58" E	92.00

LINE	BEARING	DISTANCE
L1	N 67°10'29" W	30.69
L2	N 27°49'51" E	138.05
L3	N 47°09'00" E	187.89
L4	S 47°14'58" E	92.00

LINE	BEARING	DISTANCE
L1	N 67°10'29" W	30.69
L2	N 27°49'51" E	138.05
L3	N 47°09'00" E	187.89
L4	S 47°14'58" E	92.00

LINE	BEARING	DISTANCE
L1	N 67°10'29" W	30.69
L2	N 27°49'51" E	138.05
L3	N 47°09'00" E	187.89
L4	S 47°14'58" E	92.00

LINE	BEARING	DISTANCE
L1	N 67°10'29" W	30.69
L2	N 27°49'51" E	138.05
L3	N 47°09'00" E	187.89
L4	S 47°14'58" E	92.00

LINE	BEARING	DISTANCE
L1	N 67°10'29" W	30.69
L2	N 27°49'51" E	138.05
L3	N 47°09'00" E	187.89
L4	S 47°14'58" E	92.00

LINE	BEARING	DISTANCE
L1	N 67°10'29" W	30.69
L2	N 27°49'51" E	138.05
L3	N 47°09'00" E	187.89
L4	S 47°14'58" E	92.00

LINE	BEARING	DISTANCE
L1	N 67°10'29" W	30.69
L2	N 27°49'51" E	138.05
L3	N 47°09'00" E	187.89
L4	S 47°14'58" E	92.00

LINE	BEARING	DISTANCE
L1	N 67°10'29" W	30.69
L2	N 27°49'51" E	138.05
L3	N 47°09'00" E	187.89
L4	S 47°14'58" E	92.00

LINE	BEARING	DISTANCE