

DETAIL
1"=200'



SCALE: 1"= 1000'
BEARINGS ARE BASED ON THE WYOMING COORDINATE SYSTEM
NAD 1983, EAST CENTRAL ZONE. DISTANCES ARE MULTIPLIED
TO SURFACE BY THE DATUM ADJUSTMENT FACTOR OF 1.000247.



LEGEND:

- 3-1/4" ALUMINUM CAP PER PLS 2615
- 2" ALUMINUM CAP PER PLS 5369
- 2" ALUMINUM CAP PER PLS 2615
- 1-1/2" ALUMINUM CAP PER PLS 258
- No. 5 REBAR
- BLM BRASS CAP
- NOT FOUND/NOT SET
- POB POINT OF BEGINNING
- POT POINT OF TERMINUS
- SECTION LINE
- INTERIOR SECTION LINE
- PROPERTY LINE THIS SURVEY
- FENCE LINE
- RIGHT OF WAY LINE

LEGAL DESCRIPTION

Township 54 North, Range 84W, 6th P.M., Sheridan County, Wyoming

Section 5: Lot 4, SW4NW4, W2SW4

Section 6: ALL except the following tract of land

A tract of land being all of Lots 4 and 5 and portions of Lot 3, Lot 6, SE4NW4, SW4NE4, NE4SW4 and the NW4SE4 of said Section 6; being more particularly described as follows:
Beginning at the northwest corner of said Section 6 (monumented with a 3" BLM Brass Cap);
thence N89°02'49"E, 1724.53 feet along the north line of said Section 6 to a point on the east line of a tract of land described in document #2023-787185 and lying on a fence line, not monumented this survey;
thence S28°12'13"E, 1573.06 feet along said east line and said fence line to a 2" aluminum cap per PLS 5369;
thence S78°20'46"E, 215.26 feet along said east line and said fence line to a 2" aluminum cap per PLS 5369;
thence S83°47'23"E, 239.78 feet along said east line and said fence line to a 2" aluminum cap per PLS 5369;
thence S03°25'58"E, 226.15 feet along said east line and leaving said fence line to a 2" aluminum cap per PLS 5369;
thence S26°41'57"E, 1482.78 feet along said east line to a 2" aluminum cap per PLS 5369 being the southeast corner of said tract described in document #2023-787185;
thence N84°54'00"W, 3600.69 feet to a 2" aluminum cap per PLS 5369 lying on the west line of said Section 6;
thence N00°13'17"W, 2657.38 feet along said west line POINT OF BEGINNING.

Section 7: Lot 1, Lot 2, E4NW4, N4NE4
Section 8: NW4NW4, EXCEPT a 1-acre tract of land (Book 269 of Deeds, Page 52) lying in the NW4NW4 of Section 8, more particularly described as follows: The Southerly 208.71 feet of the easterly 208.71 feet of the NW4NW4 of said Section 8. The above described parcel contains 1.0 acre.

Township 54 North, Range 84W, 6th P.M., Sheridan County, Wyoming

A tract of land situated in Lot 1, Lot 3, Lot 4, E4NW4, W4NE4, E4SE4 of Section 30, Lot 1, Lot 2, Lot 3 E4E, E4W4 of Section 31, SW4NW4, W4SW4 of Section 32; being more particularly described as follows:

Beginning at the southeast corner of said Section 31 (monumented with a 3/4" aluminum cap per PLS 2615);
thence S89°02'49"W, 3499.93 feet along the south line of said Section 6 to a point on the easterly line of a tract of land described in document #2023-787185 and lying on a fence line, not monumented this survey;
thence N28°10'08"W, 105.37 feet along said easterly line and said fence line to a 2" aluminum cap per PLS 5369;
thence N68°08'53"E, 818.99 feet along said easterly line and leaving said fence line to a 2" aluminum cap per PLS 5369 lying on a fence line;
thence N32°24'09"E, 418.91 feet along said easterly line and said fence line to a 2" aluminum cap per PLS 5369;
thence N30°08'16"W, 164.13 feet along said easterly line and said fence line to a 2" aluminum cap per PLS 5369;
thence S71°55'20"W, 445.51 feet along said easterly line and said fence line to a 2" aluminum cap per PLS 5369;
thence N33°16'14"W, 2054.75 feet along said easterly line and leaving said fence line to a 2" aluminum cap per PLS 5369 lying on a fence line;
thence N10°19'50"W, 2809.36 feet along said easterly line and said fence line to a 2" aluminum cap per PLS 5369;
thence N33°26'58"E, 434.42 feet along the east line of a Boundary Line Adjustment parcel as shown on Record of Survey #A-787 and recorded in document #2023-800568 to a 2" aluminum cap per PLS 5369;
thence N17°01'53"E, 1593.29 feet along said east line to a 3/4" aluminum cap per PLS 2615 being the southeast corner of Lot 1 of the C & G Minor Subdivision;
thence N13°47'17"E, 758.15 feet along the east line of said Lot 1 to a No. 5 rebar;
thence N11°41'34"E, 64.38 feet along said east line to a No. 5 rebar being the northeast corner of said Lot 1;
thence S89°33'57"W, 202.09 feet along the north line of said Lot 1 to a 1/4" aluminum cap per PLS 258 being the southeasterly corner of a tract of land described in Book 571 of Deeds, Page 122;
thence N37°49'26"E, 288.32 feet along the easterly line of said tract to a 1/4" aluminum cap per PLS 258;
thence S47°57'06"E, 146.90 feet along said easterly line to a 1/4" aluminum cap per PLS 258, witnessed by a 2" aluminum cap per PE&LS 3158, bears N47°57'W, a distance of 24 feet;
thence N39°22'28"E, 91.09 feet along said easterly line to a No. 5 rebar witnessed by a 2" aluminum cap per PLS 3159, bears N50°29'W, a distance of 24 feet;
thence N50°28'45"W, 133.86 feet along said easterly line to a 1/4" aluminum cap per PLS 258;
thence N18°14'04"E, 188.67 feet along said easterly line to a 1/4" aluminum cap per PLS 258;
thence N59°49'34"W, 92.21 feet along said easterly line to a 1/4" aluminum cap per PLS 258, said point lying on said easterly line of said tract described in document #2023-787185;
thence N04°38'05"W, 301.36 feet along said easterly line to a 2" aluminum cap per PLS 5369;
thence N04°43'17"E, 355.08 feet along said easterly line to a 2" aluminum cap per PLS 5369 lying on the south line of a tract of land described in Book 506 of deeds, Page 226;
thence S89°44'53"E, 455.02 feet along said south line to a 2" aluminum cap per PLS 5369 on found No. 5 rebar being the southeast of said tract, witnessed by a 2" aluminum cap per PLS 5369, bears N89°50'W a distance of 27.07';
thence N13°29'13"E, 231.92 feet along the east line of said tract to a 2" aluminum cap per PLS 5369;
thence N11°58'56"W, 392.04 feet along the east line of said tract to a 2" aluminum cap per PLS 5369;
thence N32°22'56"W, 104.01 feet along the east line of said tract to a 2" aluminum cap per PLS 5369, said point being the southeast corner of a tract of land described in Book 561 of Deeds, Page 606;
thence N18°40'33"W, 252.37 feet along the east line of said tract to a 2" aluminum cap per PLS 5369;
thence N73°10'56"E, 64.72 feet along said easterly line to a 3/4" aluminum cap per PLS 5369 set on found No.5 rebar;
thence N14°39'46"W, 38.02 feet to a 3/4" aluminum cap per PLS 5369 set on found No.5 rebar being the northeast corner of said tract;
thence N83°27'32"W, 766.32 feet along the north line of said tract to a 2" aluminum cap per PLS 5369, being the northeast corner of said tract and lying on the centerline of Little Goose Canyon Road, AKA County Road No. 77;
thence N18°31'58"E, 389.28 feet generally along said centerline to a 3/4" aluminum cap per PLS 2615 being the northeast corner of said Lot 1, Section 30;
thence N89°42'12"E, 1300.43 feet along the north line of said Section 30 to a 3/4" aluminum cap per PLS 2615 being the north quarter corner of said Section 30 and the northwest corner of Tract No. 2 of Boundary Line Adjustment recorded in drawer A-plot No.704;
thence S12°33'07"E, 1248.19 feet, along the west line of said Tract No.2 to a 2" aluminum cap per PLS 5369;
thence S64°43'17"E, 1183.61 feet along the south line of said Tract No. 2 to a 2" aluminum cap per PLS 5369 lying on the west line of the tract of land recorded on Record of Survey in drawer A-plot No.408;
thence S00°03'33"E, 873.87 feet along said tract to a 2" aluminum cap per PLS 5369 being the northwest corner of a tract of land described in document #2020-757270;
thence S00°08'27"W, 1029.26 feet along the west line of said tract to a 2" aluminum cap per PLS 2615;
thence S28°45'22"E, 1172.20 feet along the west line of said tract to a 2" aluminum cap per PLS 2615;
thence S18°36'55"E, 461.74 feet along the west line of said tract to a 2" aluminum cap per PLS 2615;
thence S22°02'44"E, 188.30 feet along the west line of said tract to a 2" aluminum cap per PLS 2615;
thence S18°50'21"W, 287.69 feet along the west line of said tract to a 2" aluminum cap per PLS 2615;
thence S60°36'11"W, 174.93 feet along the west line of said tract to a 2" aluminum cap per PLS 2615;
thence S54°29'44"W, 139.64 feet along the west line of said tract to a 2" aluminum cap per PLS 2615;
thence S42°44'18"W, 239.27 feet along the west line of said tract to a 2" aluminum cap per PLS 2615;
thence S62°49'07"W, 435.96 feet along the west line of said tract to a 2" aluminum cap per PLS 2615;
thence S82°08'44"W, 429.30 feet along the west line of said tract to a 2" aluminum cap per PLS 2615;
thence S19°14'10"E, 1135.61 feet along the west line of said tract to a 2" aluminum cap per PLS 2615;
thence S89°00'37"E, 1698.43 feet along the west line of said tract to a 2" aluminum cap per PLS 2615;
thence S08°10'18"E, 2420.06 feet along the west line of said tract to a 2" aluminum cap per PLS 2615;
thence S24°15'03"E, 908.66 feet along the west line of said tract to a 2" aluminum cap per PLS 2615, lying on the south line of said Section 32;
thence S89°02'04"W, 799.54 feet along said south line to the POINT OF BEGINNING.

Said Tract containing 714.95 acres more or less (Township 54 North, Range 84 West lands).

CERTIFICATE OF RECORDER

STATE OF WYOMING :ss
COUNTY OF SHERIDAN

I HEREBY CERTIFY THAT THIS PLAT WAS FILED FOR RECORD IN MY OFFICE OF AT _____ O'CLOCK ____, M.,
THIS _____, DAY OF _____, 20_____, AND RECORDED IN PLAT BOOK _____, ON PAGE _____

COUNTY CLERK

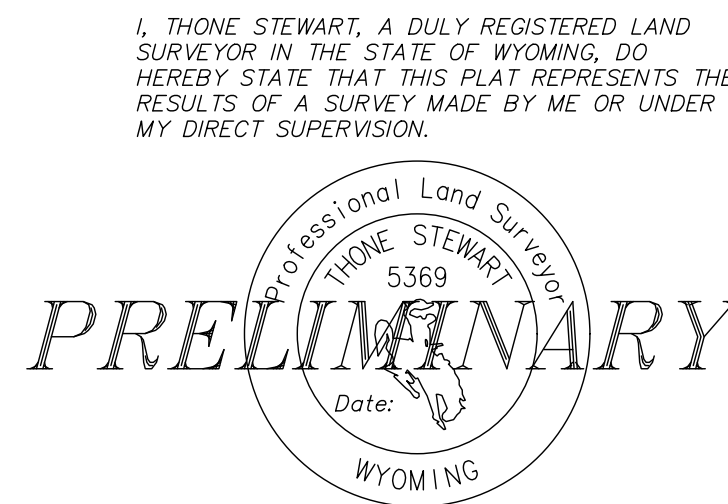

RECORD OF SURVEY
STONEBARN RANCH LLC

SITUATED LOT 4, SW4NW4, W2SW4, SEC. 5, LOTS 1, 2, 3, 7 & 8, S2NE4, SE4, E2SW4, SEC. 6, LOTS 1 & 2, E2NW4, N2NE4, SEC. 7, NW4NW4, SEC. 8, TOWNSHIP 53 NORTH, RANGE 84 WEST, LOTS 1, 3 & 4, E2NW4, W2NE4, SE4, E2SW4, SEC. 30, LOTS 1, 2, & 3, E2, E2SW4, SEC. 31, LOTS NE1/4SW1/4, AND THE W1/2SE1/4 OF SECTION 3, TOWNSHIP 55 NORTH, RANGE 84 WEST, 6TH PRINCIPAL MERIDIAN, SHERIDAN COUNTY, WYOMING

RESTFELDT
SURVEYING
2340 WETLANDS DR., SUITE 100
PO BOX 3082
SHERIDAN, WY 82801
307-672-7415

CLIENT: STONEBARN LLC

JN: 2022-061
DN: 2022-061 STONEBARN
TAB: PLAT
PF: T2022-061
REVIEWED BY:
JULY 1, 2025